



**ROBBY GORDON – TODD ROMANO**

DANIEL GRANGER – KYLE SWOBODA

**SPEED / UTV**

Design Presentation Document

FOR PUBLIC RELEASE: 04/22/2020

- **Horsepower: 230hp-300hp (e85)**
- **Wheelbase: 120"**
- **Ground clearance: 15"**
- **32" tires stock , will clear up to 35" tires**





**Rod Milliken**

Apr. 20 at 2:37 p.m. • 



Does anyone know the width of the carbon seats? I'm kind of a fat bastard and was curious what they are.



12

9 Comments



Like



Comment

**We will be offering 5 different seat styles.  
Driver seat is a free chose, other seat changes  
will be at an added cost. Will explain more in  
this presentation**



**AJ Starsiak**

Apr. 20 at 2:11 a.m. • 



Question for this weeks episode: Can you help us better understand the torque limiters in the diffs? You said there would be a clutch, and they would work independently. Is this similar to a one way bearing? Would this then allow us to tune front and rear brakes separately?



6

4 Comments

**The incorporated torque limiting clutch that will protect the drivetrain from torque spike loads is a friction clutch and works in both directions.**

**That means it works on torque spikes coming from the ground or the engine in forwards and reverse**



**Mary Clayson Peterson**

Apr. 18 at 4:38 p.m. • 📷

What is the difference between the 4 seater and the truck ?

One says limited edition?



5

12 Comments



**Brady Black**

Apr. 18 at 2:10 p.m. • 📷

If I order a speed UTV what other charges am I looking at? I live in Utah. Obviously sales tax and licensing but what else. Also if I order a 72" 2 seat UTV when should it be available? Are the 500 limited edition UTV's going to restart with the 72" Production?



12

13 Comments

### 3 Limited Edition Vehicles:

- 95" WB 2 seat UTV
- 110" WB 2 Seat UTT
- 120" WB 4 Seat UTV

**All Limited edition vehicles are only available as 77"**

- 10" Configurable Display
- Bluetooth & Wi-Fi connectivity
- Phone screen mirroring (Google maps, maps.me, buddy tracker, etc.)





- Multiple Display Modes

- Phone Screen Mirroring



- **5 Seat options:**
  - Tall & Wide
  - Standard
  - Standard Full Containment
  - Child Full Containment
  - Standard Height & Wide (not pictured)
- **Seat & Body Measurements will be published**





- **3 Forward Gears**
  - **P-R-N-Lo-Hi-CRUISE**
- **Largest input shaft on the market**
- **Industry Leading gear face width.**
- **Industry exclusive torque limiting clutch.**

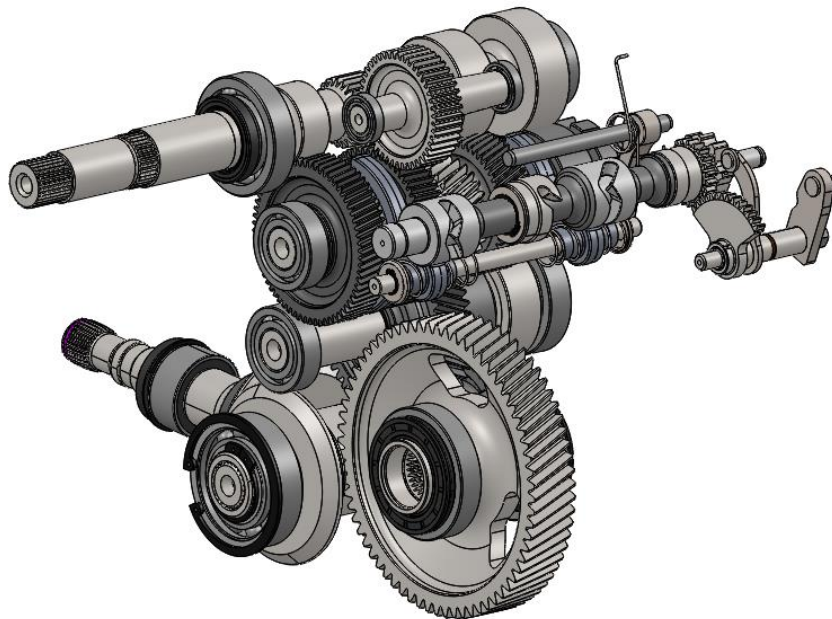

- **3 Forward Gears**
  - P-R-N-LOW-HI-CRUISE
  - 3rd Ratio is 1:1
- **Industry exclusive torque limiting clutch built into a reduction gear**

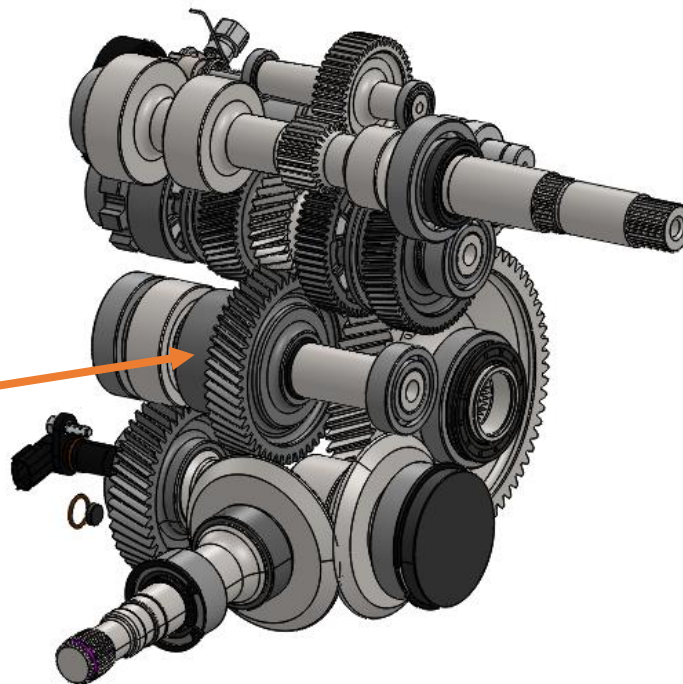

- Dogged gears  
LOW-HI-CRUISE

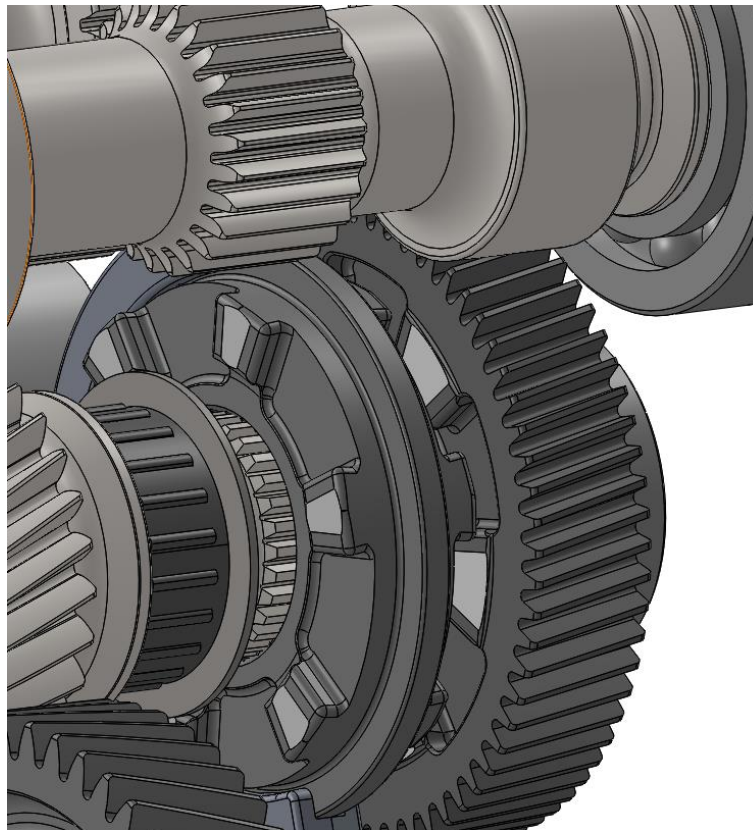

- Manual 4WD and Front Locker
- Shift on the fly thanks to Dog engagement
- Larger Ring and Pinion
- Patented CV locking mechanism (front and rear)
- Torque limiting clutch for driveline protection

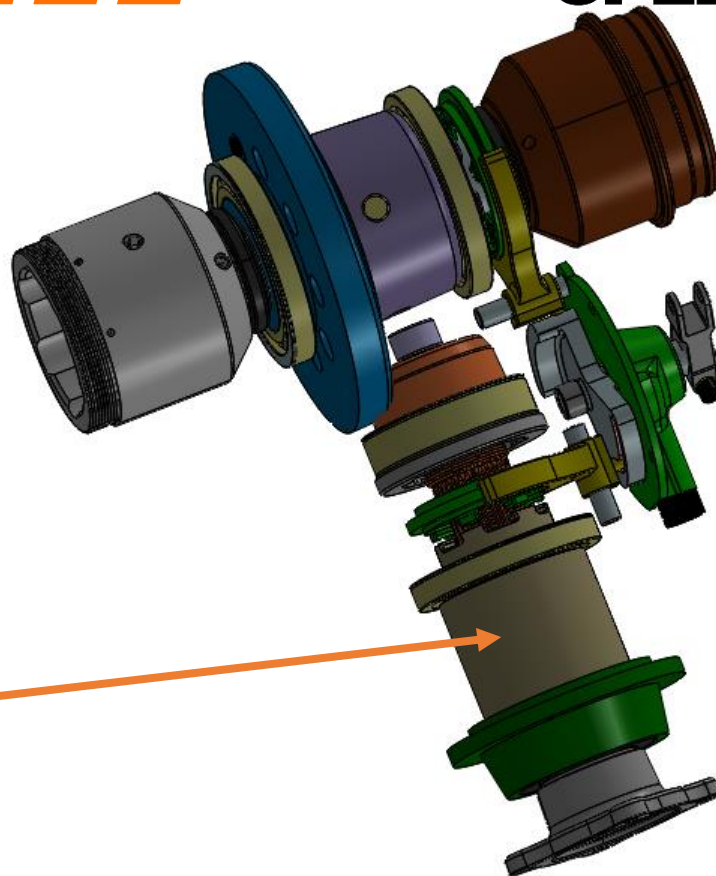

# WHEELBASE

# SPEED UTV

- **NOTE: ADD 41" TO WHEELBASE FOR OVERALL LENGTH ON ALL MODELS**

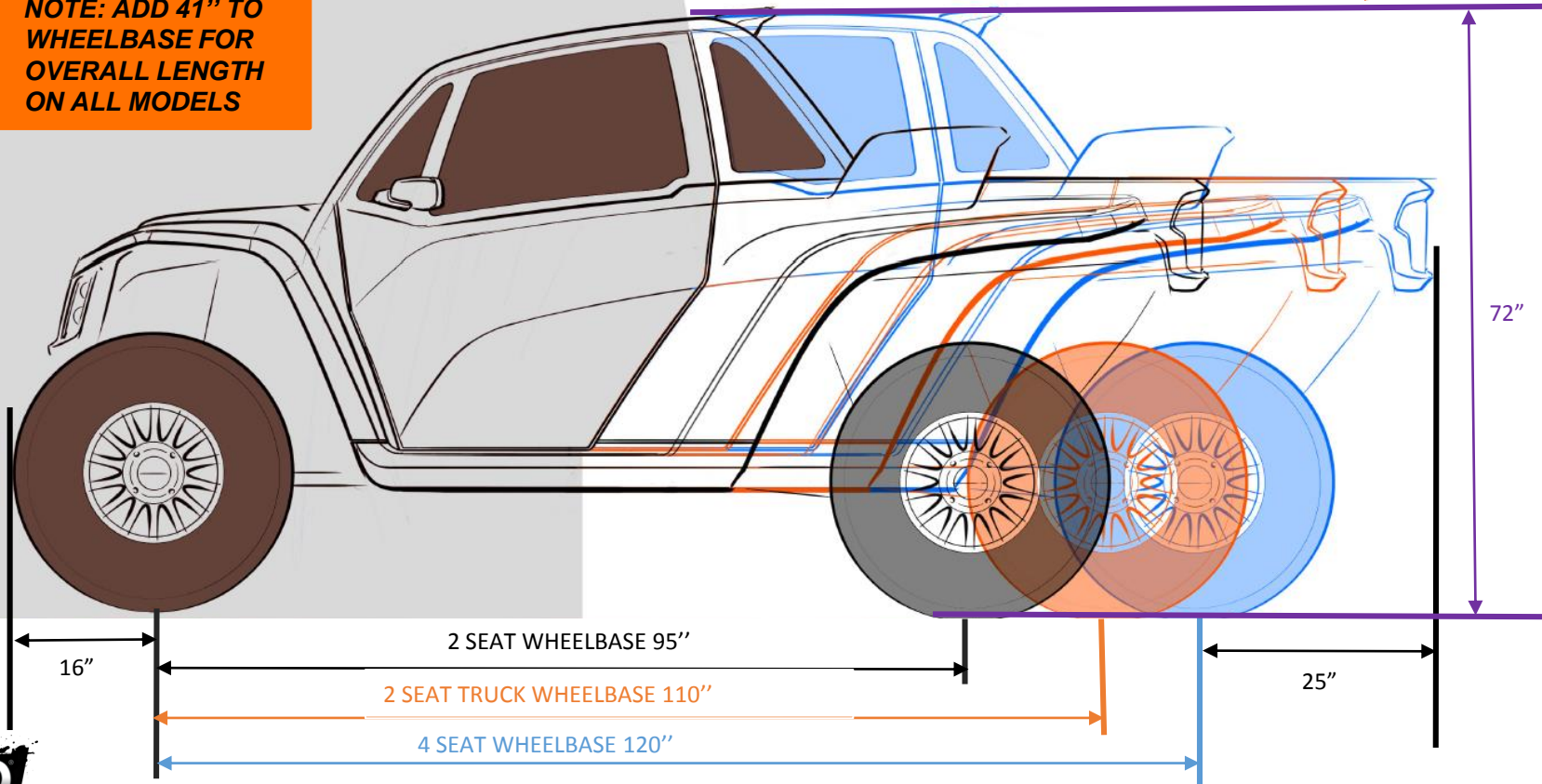

GENERAL

SUSPENSION

STEERING

CHASSIS

BODY

INTERIOR

DRIVETRAIN



# WILL IT FIT IN MY TRAILER?

**SPEED**  **UTV**

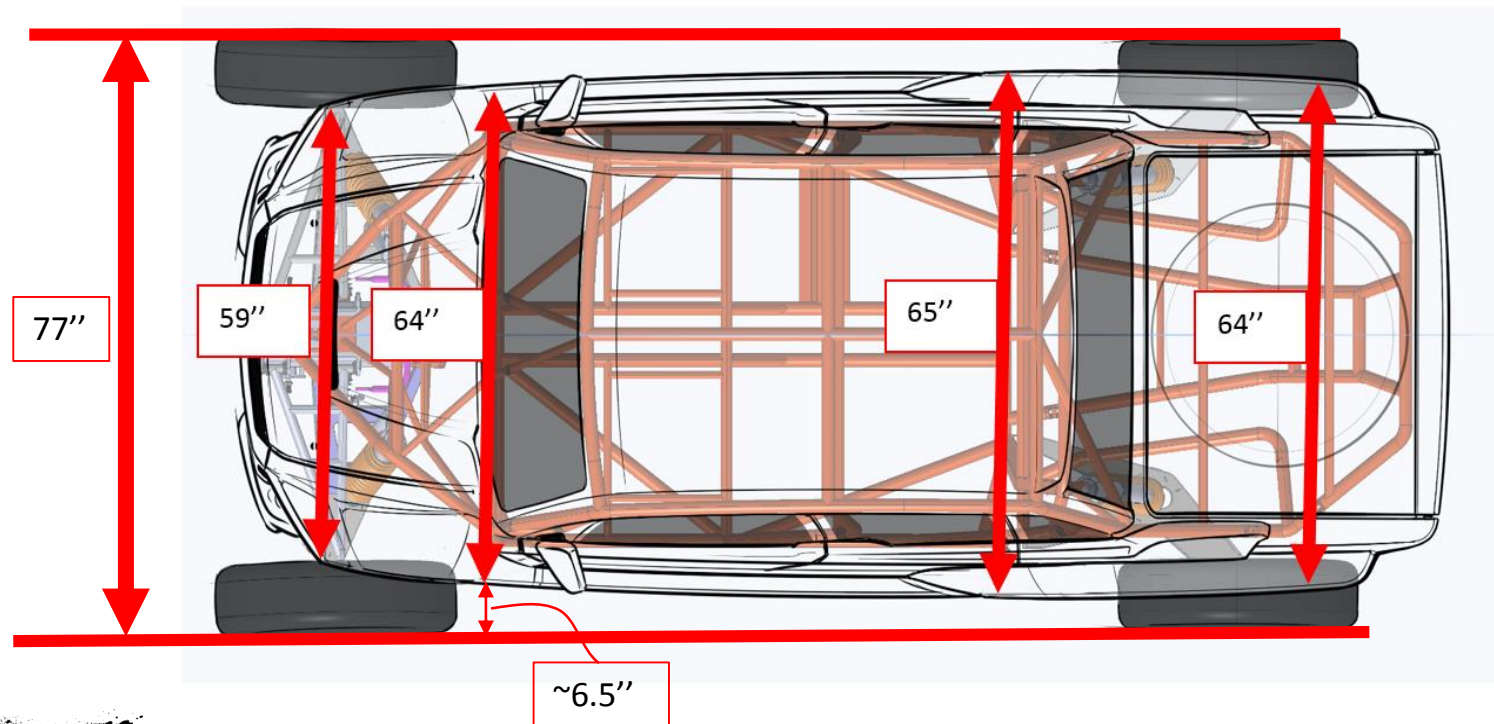

GENERAL

SUSPENSION

STEERING

CHASSIS

BODY

INTERIOR

DRIVETRAIN



BODY

**SPEED**  **UTV**



GENERAL

SUSPENSION

STEERING

CHASSIS

**BODY**

INTERIOR

DRIVETRAIN

BODY

**SPEED**  **UTV**



GENERAL

SUSPENSION

STEERING

CHASSIS

**BODY**

INTERIOR

DRIVETRAIN

BODY

**SPEED**  **UTV**

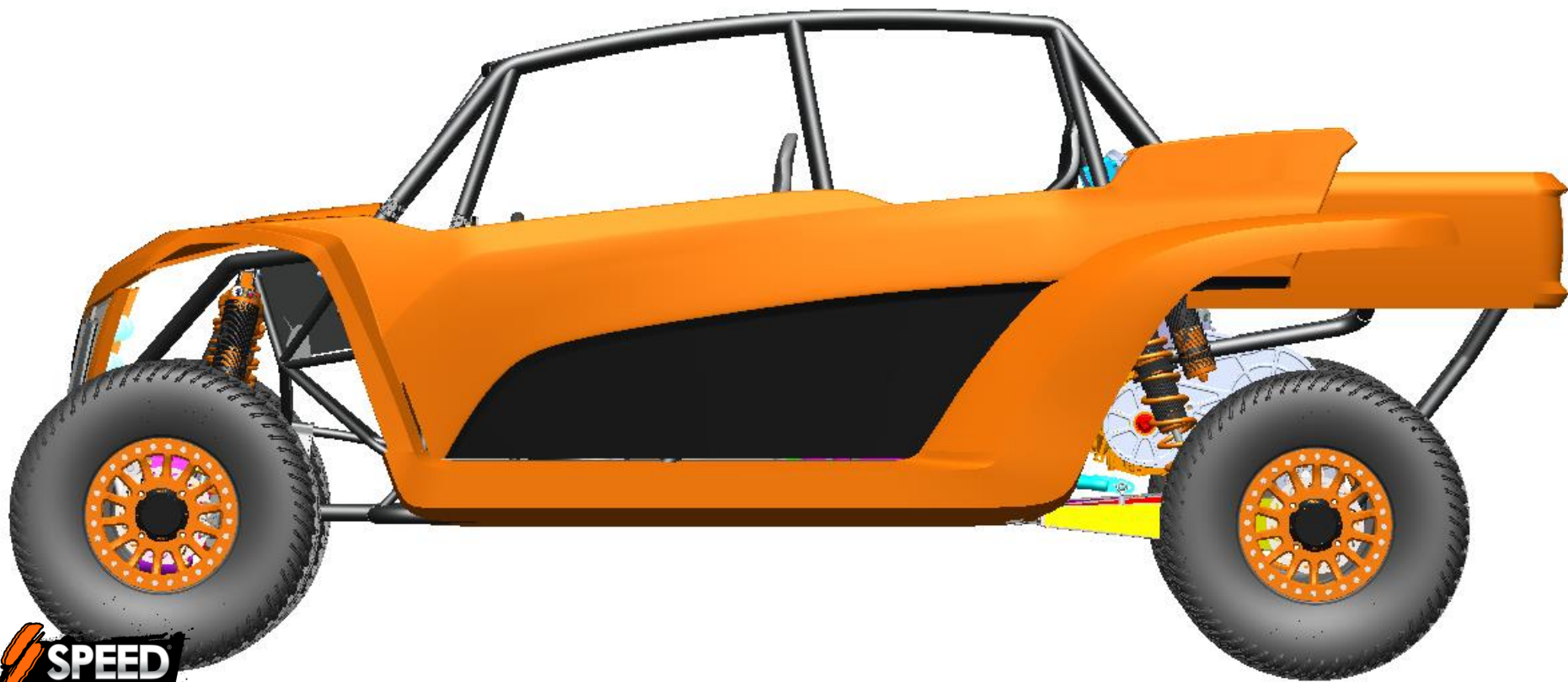

GENERAL

SUSPENSION

STEERING

CHASSIS

**BODY**

INTERIOR

DRIVETRAIN

## BODY – TAILGATE

**SPEED**  **UTV**



GENERAL

SUSPENSION

STEERING

CHASSIS

**BODY**

INTERIOR

DRIVETRAIN



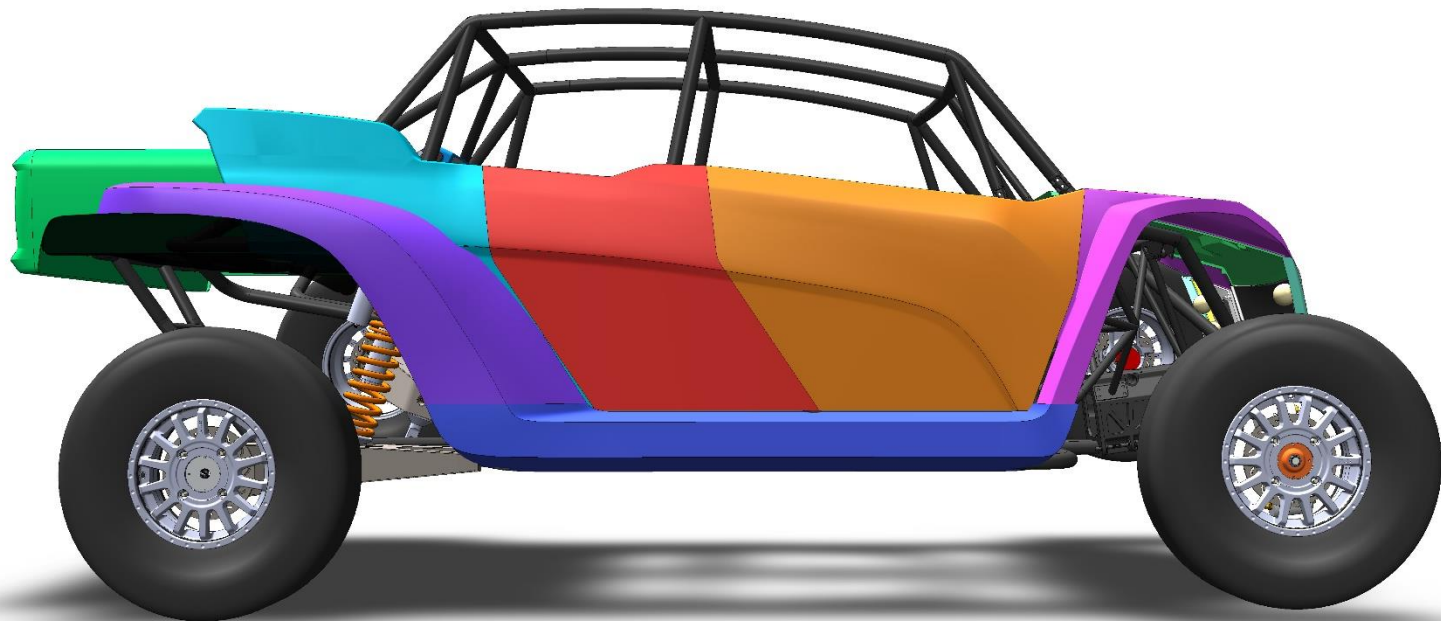

# SPEED UTT: 2 SEAT 110" WHEELBASE

# SPEED UTV

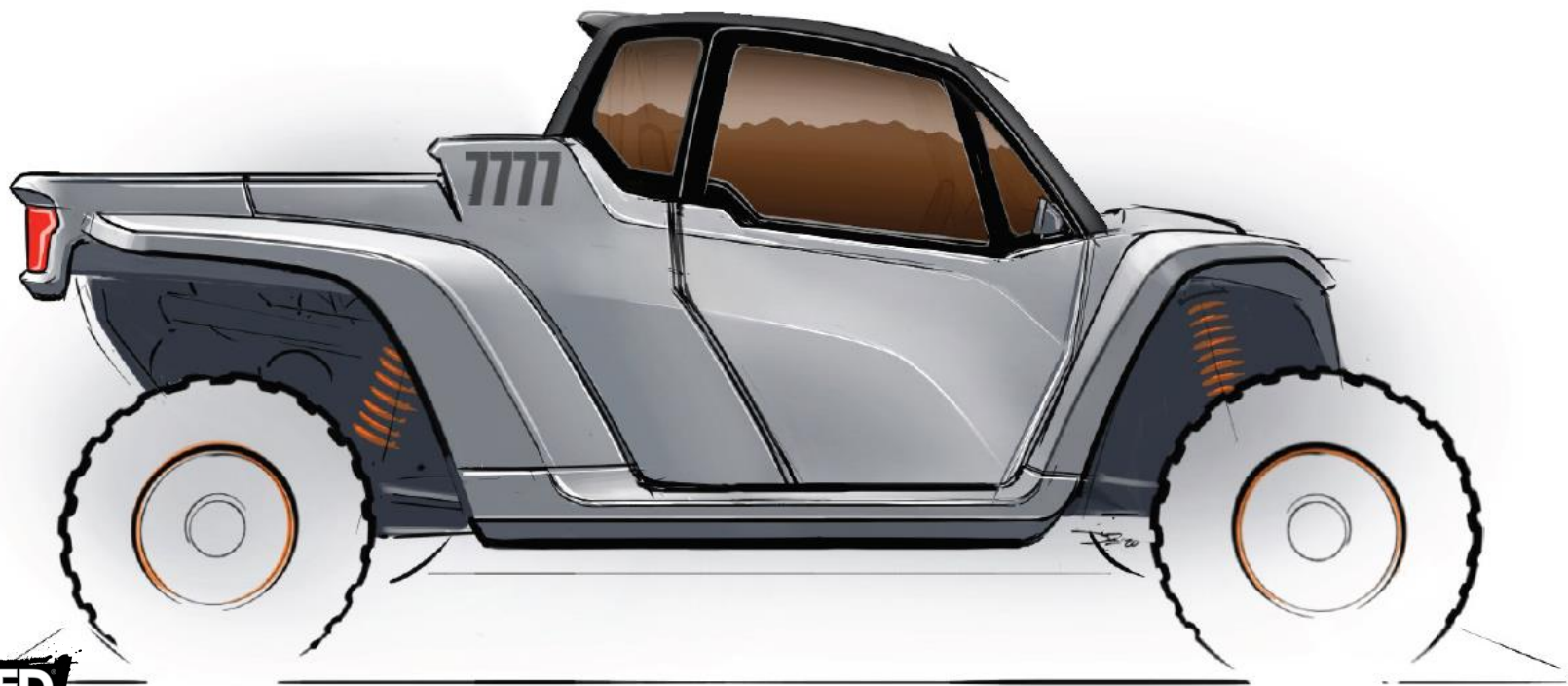

GENERAL

SUSPENSION

STEERING

CHASSIS

BODY

INTERIOR

DRIVETRAIN



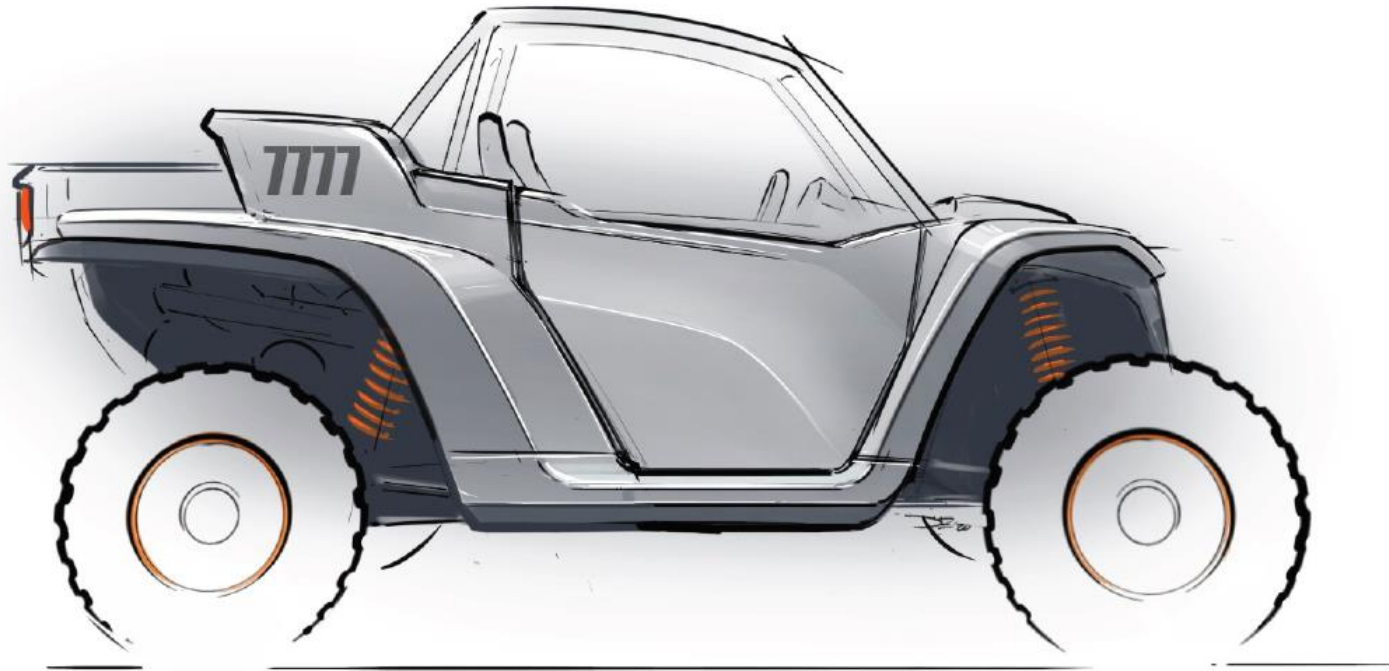

## CHASSIS SPECS

# SPEED ENERGY UTV

- Seamless tubing
- Added factory FIA style A-Pillar support
- Patented V-Bars front & Rear
- Patented Roof Spine

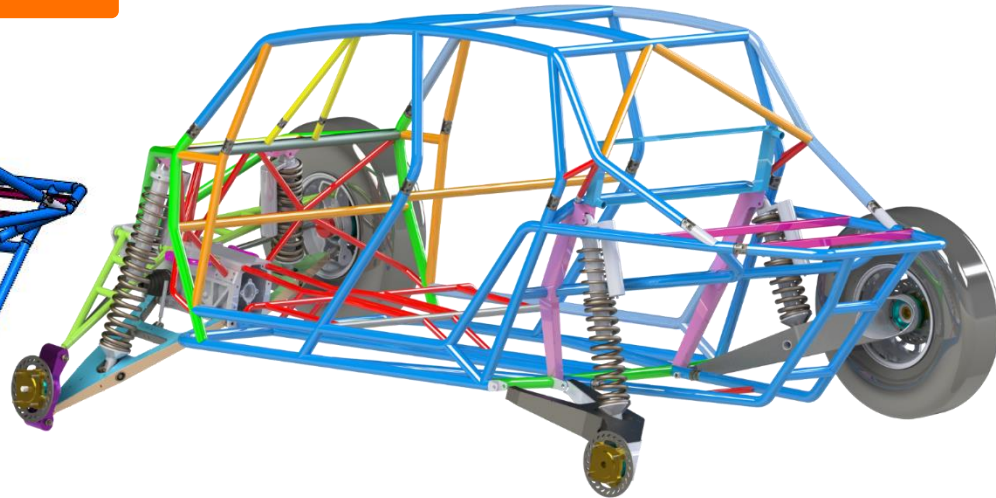
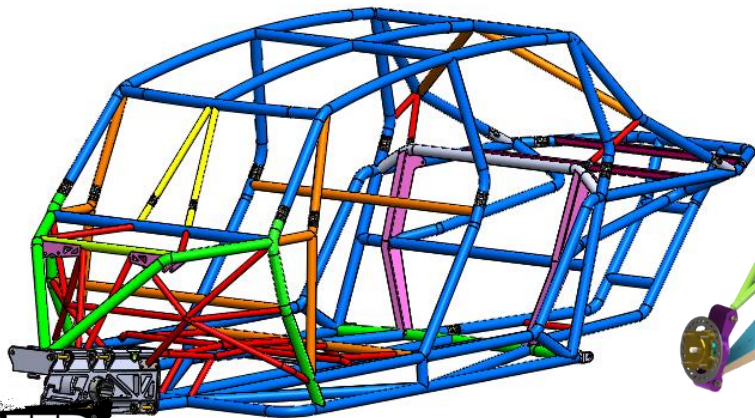
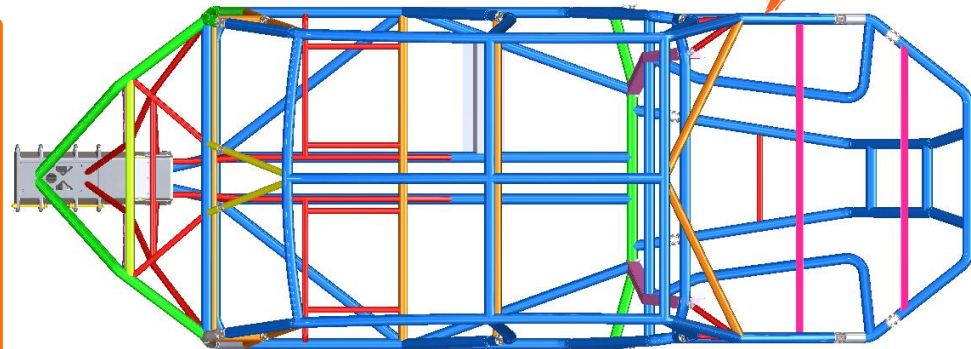

GENERAL

SUSPENSION

STEERING

CHASSIS

BODY

INTERIOR

DRIVETRAIN



1) 14 Spoke Concave



2) RG Concave



3) RG Flat – TT Style

- Speed S Branded tires
- Collaboration with reputable tire manufacture
- ~32.5" x 10" x 15" Rim





- Speed S Branded tires
- Collaboration with reputable tire manufacture
- ~32.5" x 10" x 15" Rim



- Bed is sized to accommodate 35" spare plus many additional accessories

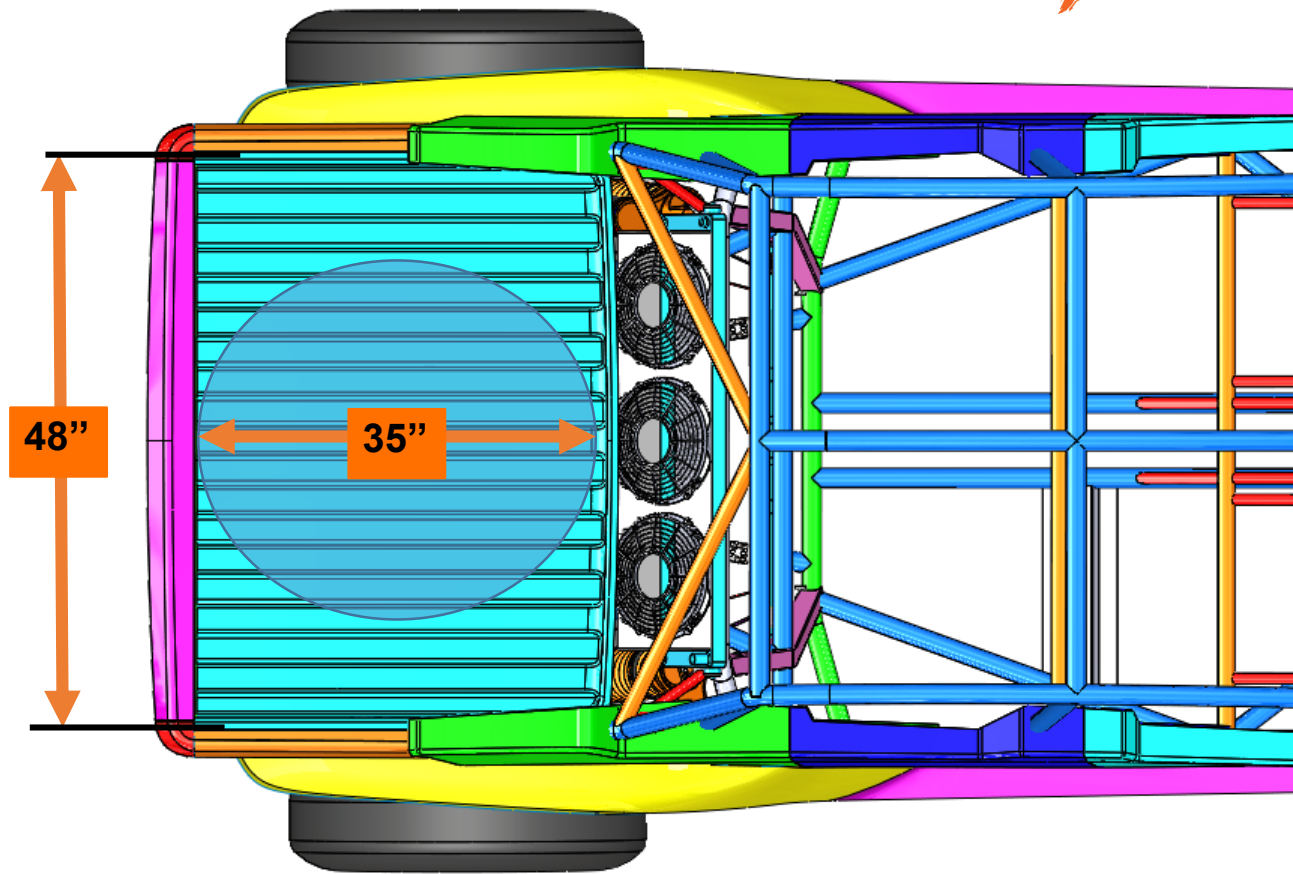



- 3.25" Internal Bypass
- 12" Stroke
- 360 degree clock-able piggyback reservoir
- External Independently adjustable rebound and compression
- Dual rate springs
- Finned reservoir



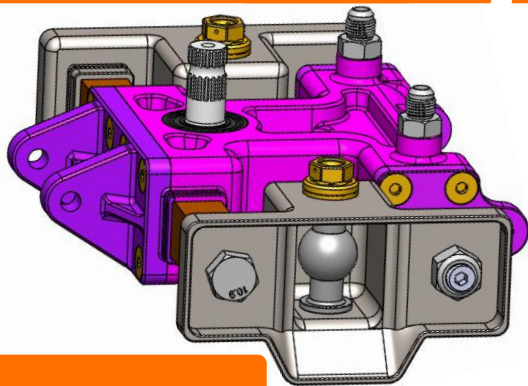

- Hydraulic assist power steering
- 1.75:1 Ratio
- Less than 0.5 deg. of Bump steer

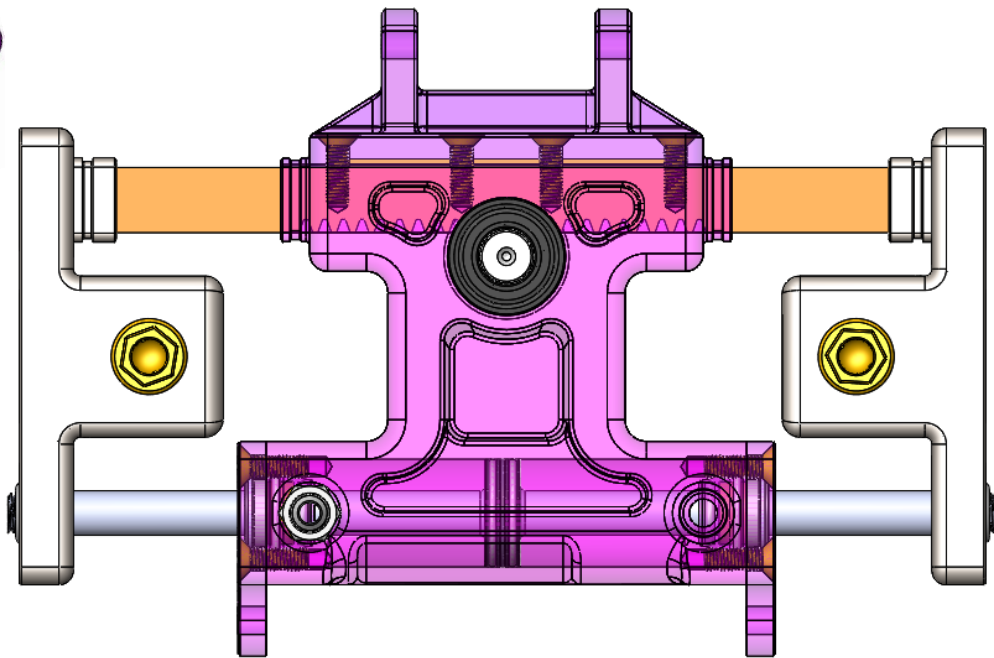

## PATTENTED BULKHEAD

**SPEED**  **UTV**



- Patented RG AWD Trophy Truck (Unicorn) inspired Bulkhead
- Mounts suspension, steering, and front differential all in one structure



GENERAL

SUSPENSION

STEERING

CHASSIS

BODY

INTERIOR

DRIVETRAIN

- 230Hp (300 Hp on E-85)
- 999CC
- Turbocharged
- 2 Injectors per cylinder
- 4-Valve DHOC

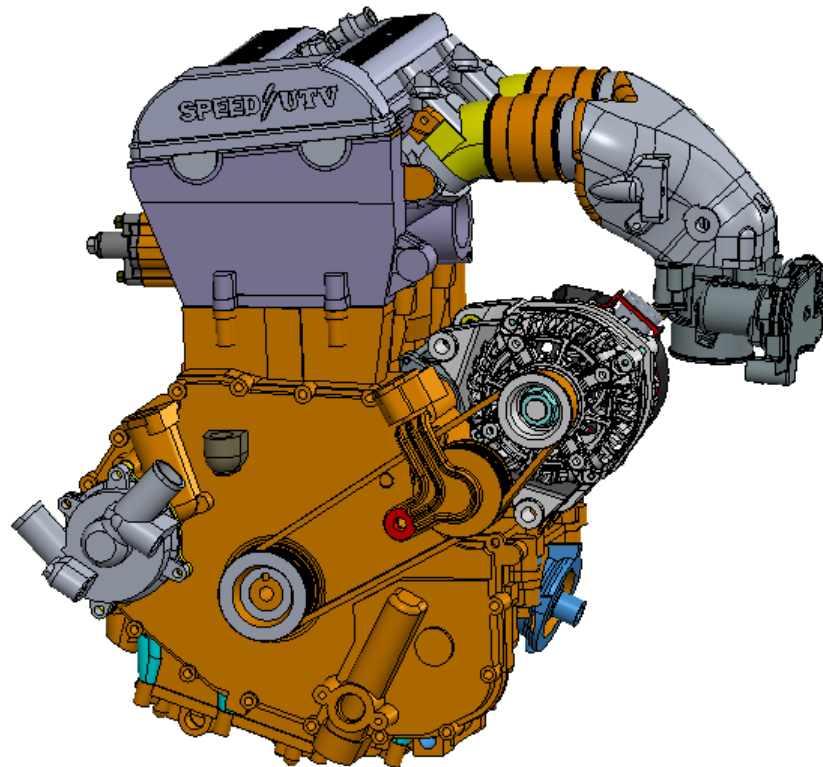

- Bore: 98mm
- Stroke: 66.2mm
- Number of Cylinders: 2
- 4 valves per cylinder
- Forged, Rods, Pistons & Crank

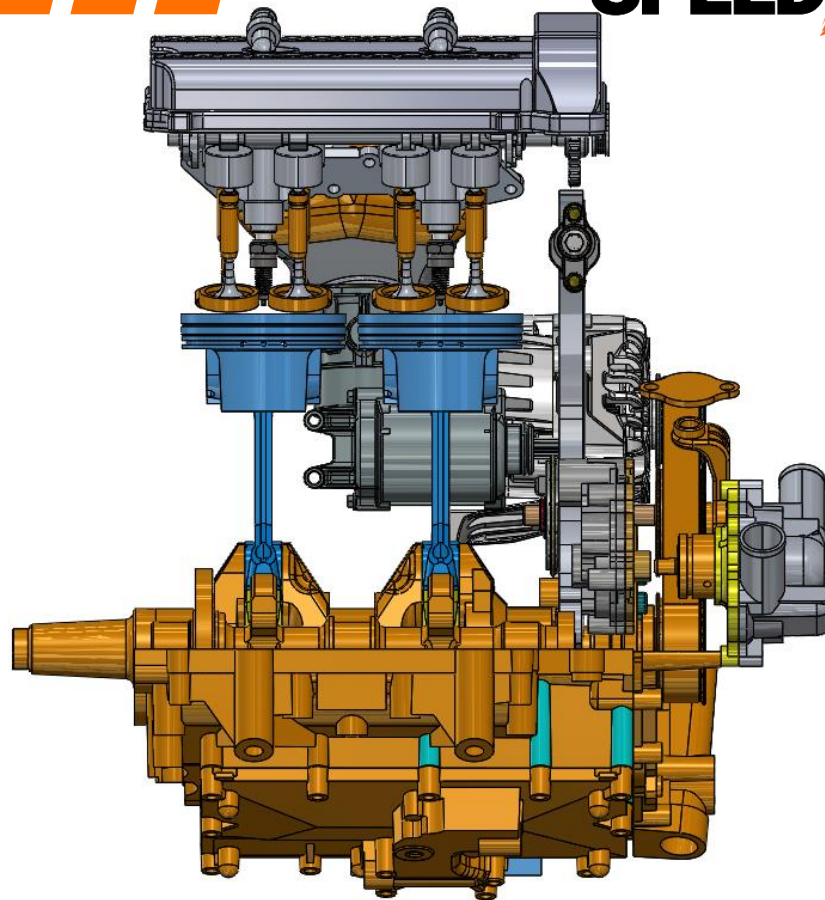

- Ports designed by Indy Car/NASCAR/Racing Motor Engineer
- Flow optimized for maximum efficiency and minimized hot spots
- 12mm Spark plugs
- Dedicated cooling circuits for ports and sparkplug

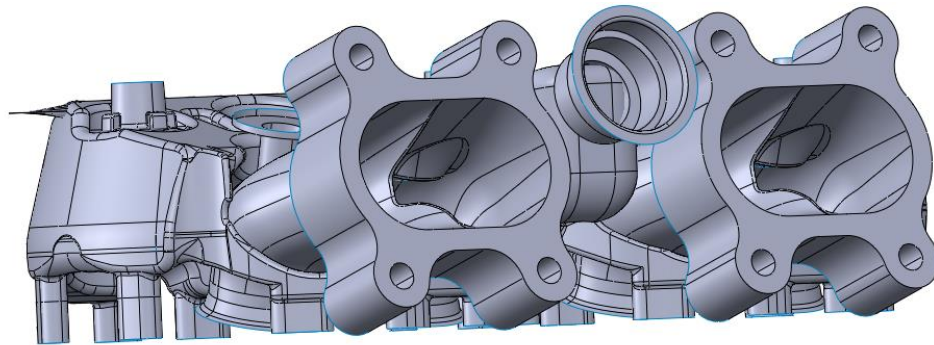
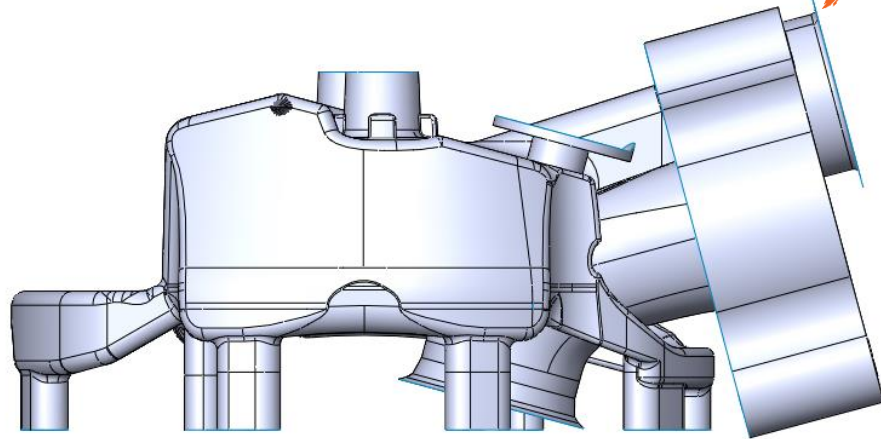



- Forged Aluminum Upright
- Universal Hub and bearing (all 4 corners)
- Fully shouldered bolts

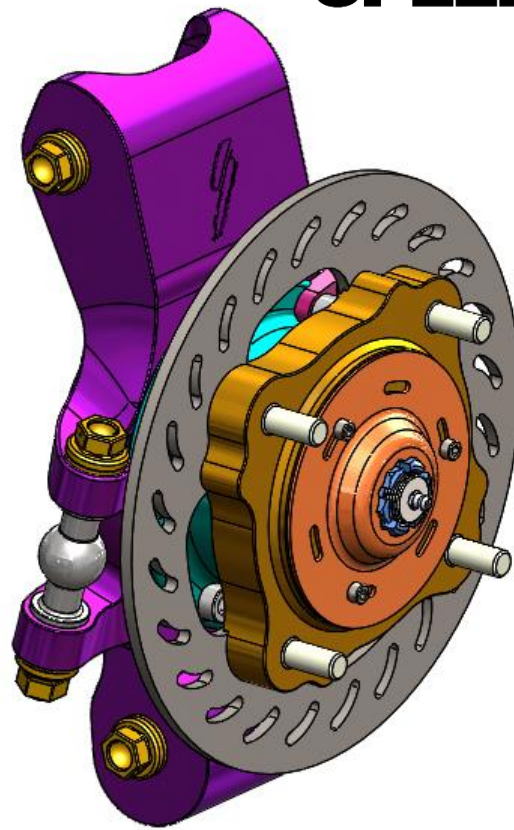
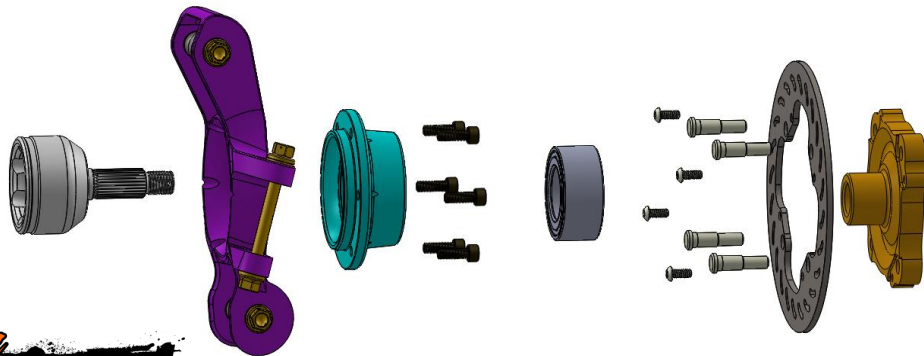

**New Live Stream Every  
Wednesday evening**

**Stay tuned to our media  
channels for updates  
@SpeedUTV**

**Place your preorder:**

**[www.SpeedUTV.com](http://www.SpeedUTV.com)**



**Design Presentation Document**

**SPEED / UTV**