

KWI CLUTCH PACKAGE INSTALLATION

VERSION: 2.0

DATE: 2026/06/30

PURPOSE:

This procedure outlines the process for installing the Speed UTV KWI Clutch Package.

SCOPE:

This procedure applies to Speed UTV vehicles requiring KWI Clutch Package installation during service or production.

MODEL NOTE:

Images in this procedure show an El Diablo vehicle. Some hardware locations may vary slightly by model or configuration. Use photos as a reference for component location and orientation.

SAFETY PRECAUTIONS:

Ensure the vehicle is parked on a stable, level surface before beginning work.

Allow hot components to cool before removal or installation.

Wear proper PPE, including gloves and eye protection.

Support removed panels and components to prevent damage or injury.

Keep hands clear of pinch points when removing or installing the clutch components.

TOOLS REQUIRED

- | | |
|--|--|
| <ul style="list-style-type: none">○ Torque wrench○ Impact wrench○ Ratchet○ Clutch puller○ Pry bar○ Drill○ 10 mm drill bit○ M8 x 1.25 mm bolt○ T60 socket with extension○ 2.5 mm hex | <ul style="list-style-type: none">○ 5 mm hex○ 7 mm socket○ 10 mm socket○ 11 mm socket○ 13 mm socket○ 15 mm socket○ 19 mm socket○ 13 mm wrench○ 14 mm wrench○ 19 mm wrench |
|--|--|

MATERIALS / CONSUMABLES

- Speed UTV KWI Clutch Package
- Red grease
- Blue medium-strength threadlocker
- Anti-seize compound
- Brake cleaner or equivalent residue-free cleaning solvent
- Shop towels or paper towels
- Zip ties

1. Removing Bed and Old Ducting

STEP 1:

Disconnect the taillight wiring, camera wiring if equipped, and remove any zip ties securing wiring or components to the bed. Then remove the bed hardware using a 5 mm hex.



NOTE: Do not remove the rear fenders from the bed. The bed and rear fenders should be removed together as an assembly. Slide the assembly rearward and carefully work it clear of the vehicle.

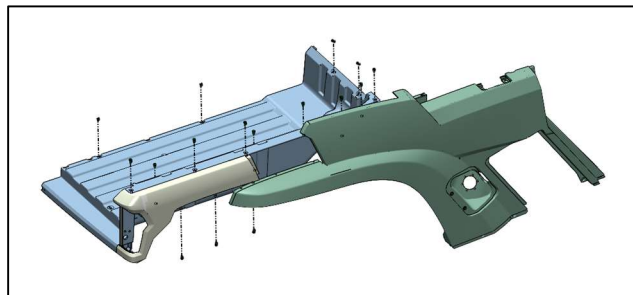
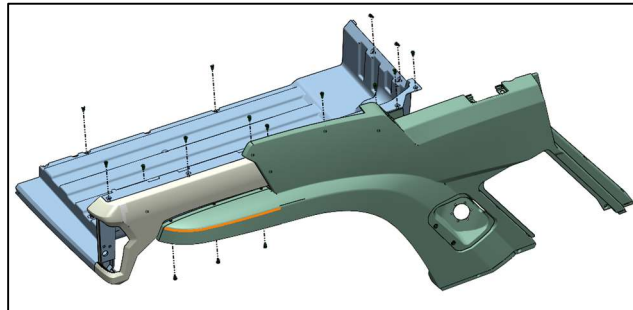

STEP 2:

Loosen the hose clamps on the ducting crosschamber using a 7 mm socket.



STEP 3:

Using a 7 mm socket, loosen the hose clamps securing the rubber ducting adapters. Remove the rubber ducting adapters from the vehicle.



STEP 4:

Using a 7 mm socket, loosen the hose clamps securing the CVT Y-pipe. Remove the CVT Y-pipe from the vehicle.



STEP 5:

Remove the inboard filter screen from the air filter body using a 2.5 mm hex.



STEP 6:

Remove the air filter body using a 5 mm hex. Once removed, remove the outboard filter screen from the old air filter body using a 5 mm hex.



2. Removing Old Clutch Package

STEP 7:

Remove the clutch cover by releasing the three latches.



STEP 8:

NEW STYLE: Thread a bolt into the secondary clutch plate to relieve spring tension. Make sure the bolt does not line up with a hole in the inner plate.

OLD STYLE: Use a pry bar to open the spring-loaded secondary clutch and relieve belt tension.

WARNING: Keep fingers and hands clear while the secondary clutch is under spring tension.

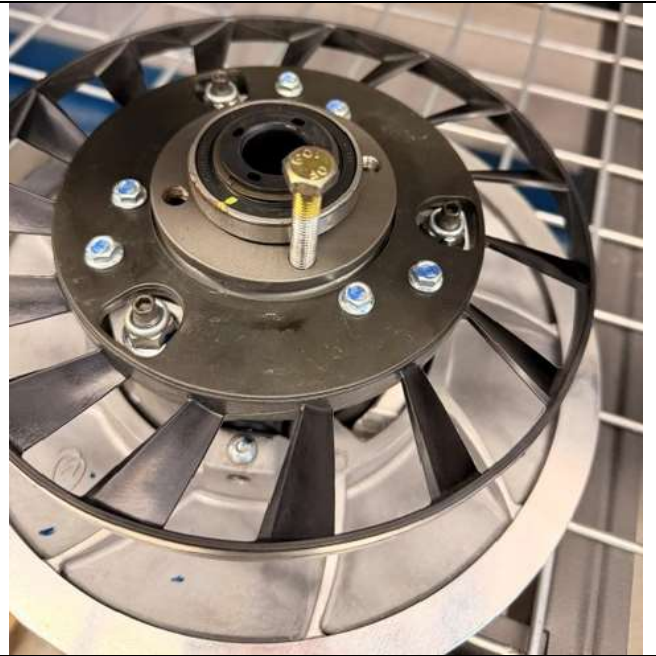

STEP 9:

Remove the CVT belt from the primary and secondary clutches.



STEP 10:

Remove the secondary clutch mounting bolt using a 19 mm socket, then remove the secondary clutch.

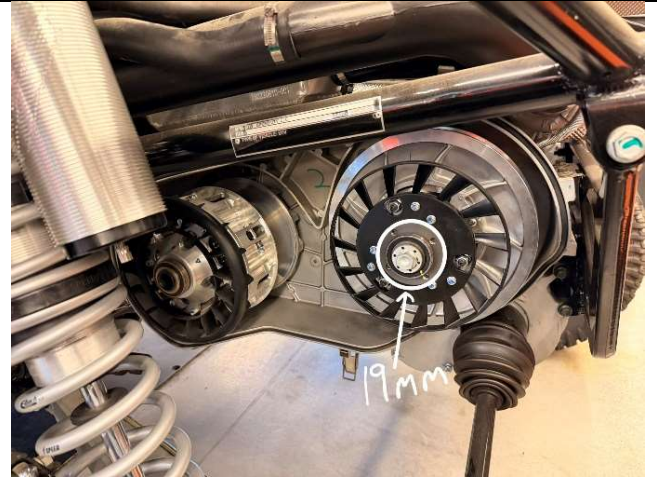

STEP 11:

Remove the primary clutch mounting bolt using a T60 socket and extension. Move the shock if additional access is needed.



STEP 12:

Thread the clutch puller into the primary clutch and run it in with an impact until the clutch releases from the shaft.

NOTE: A loud pop may be heard when the clutch releases.

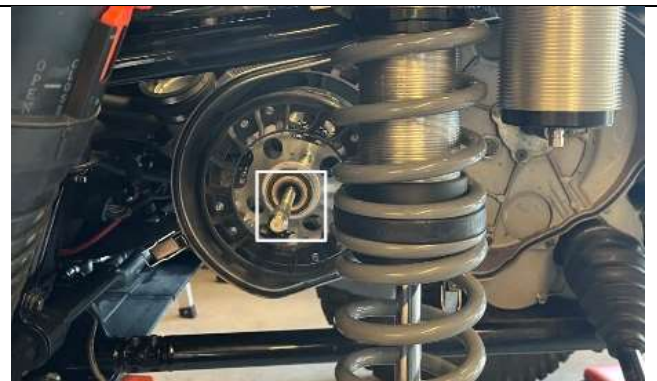

STEP 13:

Using a 5 mm hex, remove the eight clutch case bolts shown.



STEP 14:

Using a 10 mm socket, remove the four clutch case bolts shown. **Note each bolt length and location** so each bolt can be reinstalled in its original hole.

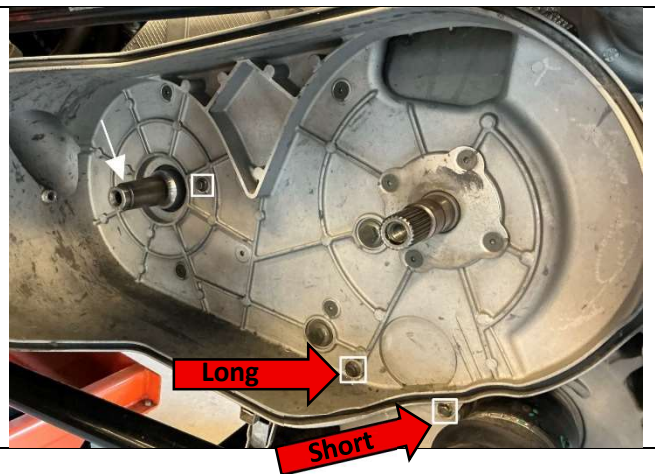

STEP 15:

Using a 10 mm socket, remove the two rear clutch case bolts located near the exhaust and rear crossmember.

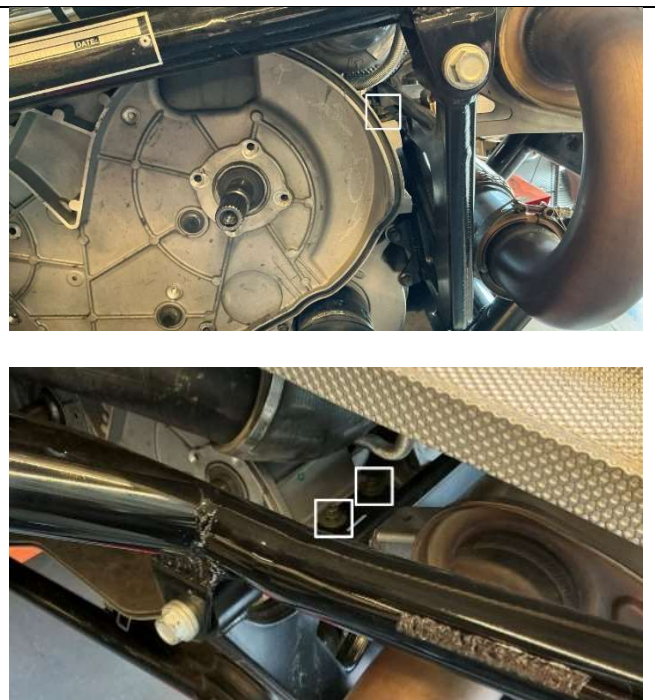

STEP 16:

Using a 15 mm socket, remove the upper tie bolt shown. Reinstall the same bolt from the passenger side to maintain engine/transmission alignment.



STEP 17:

Using a 15 mm socket, remove the lower tie bolt shown. Reinstall the same bolt from the passenger side to maintain engine/transmission alignment.



STEP 18:

Remove the clutch case, leaving the two tie bolts installed from the passenger side.

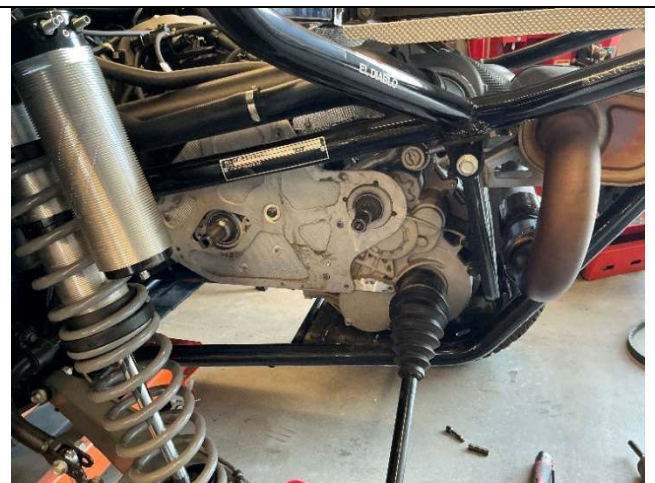

3. New Ducting Install

STEP 19:

Assemble the new air filter body using a 2.5 mm hex.



STEP 20:

Reinstall the existing outboard filter screen onto the new air filter body using a 5 mm hex.



STEP 21:

Install the new air filter body onto the vehicle.



STEP 22:

Reinstall the existing inboard filter screen using a 2.5 mm hex.



STEP 23:

Transfer one clip nut from the old air filter body to the new air filter body.



STEP 24:

Using a 7 mm socket, tighten the hose clamps securing the hose between the air filter body and air filter canister.



STEP 25:

Install the primary ducting and tighten the hose clamps using a 7 mm socket.



STEP 26:

Install the secondary ducting and tighten the hose clamps using a 7 mm socket.



STEP 27:

Install the intake adapter onto the ducting crosschamber.



STEP 28:

Install the ducting crosschamber and tighten the hose clamps using a 7 mm socket.



4. Exhaust Removal

STEP 29:

Using an 11 mm socket, loosen the two exhaust clamps and remove the exhaust pipe.

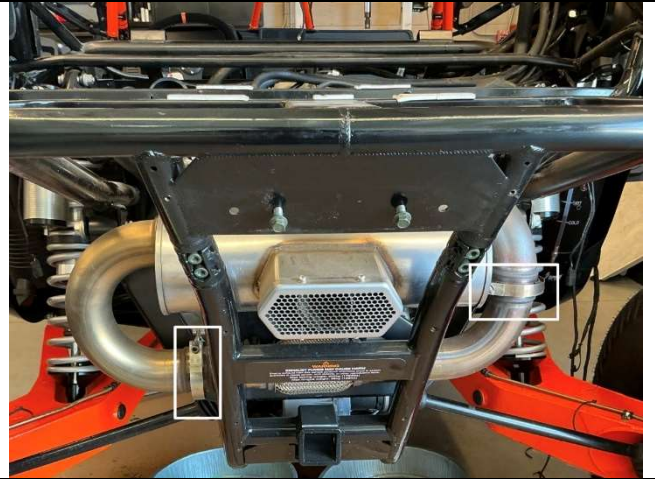

STEP 30:

Using a 13 mm socket, remove the muffler mounting bolts, then remove the muffler.

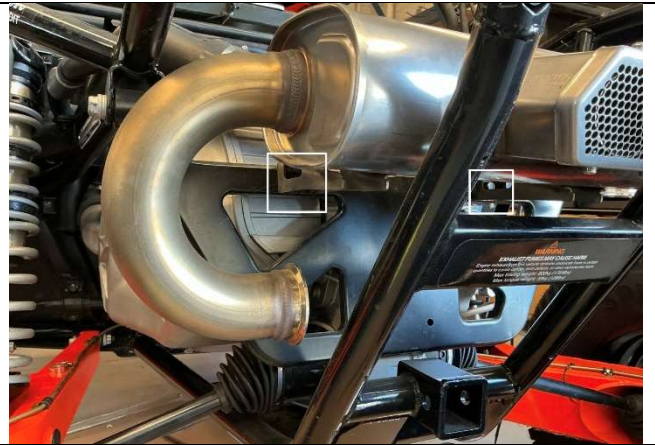

5. Removing Rear Crossmember

STEP 31:

Using a 13 mm socket and 14 mm wrench, remove the two transmission mounting bolts.

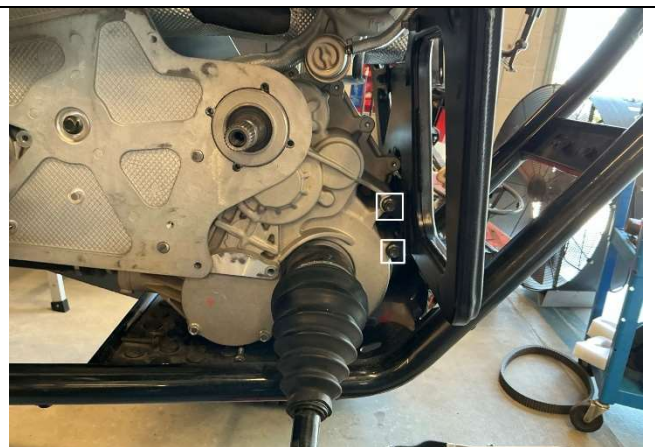

STEP 31 (continued):

Transmission mounting bolt location.



STEP 32:

Using a 10 mm socket and 13 mm wrench, remove the turbo mounting bracket bolts.



STEP 33:

Using a 19 mm socket and 19 mm wrench, remove the two upper rear crossmember bolts. Remove the rear crossmember.



6. New Clutch Case Install

STEP 34:

Apply red grease to the O-ring, then install it into the back intake plate.

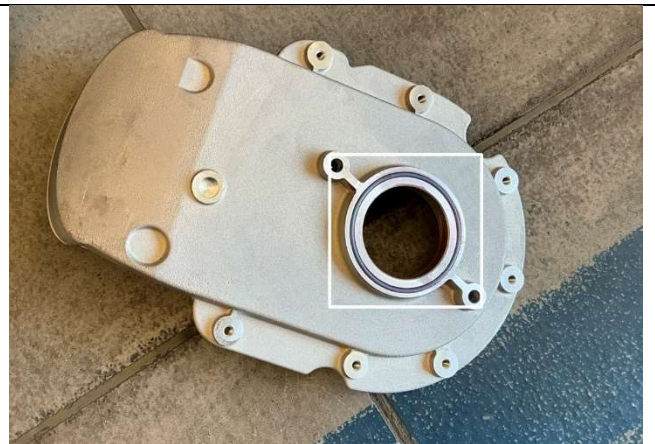

STEP 35:

Install the back intake plate onto the clutch case using seven M6 bolts, blue medium-strength threadlocker, and a 5 mm hex.

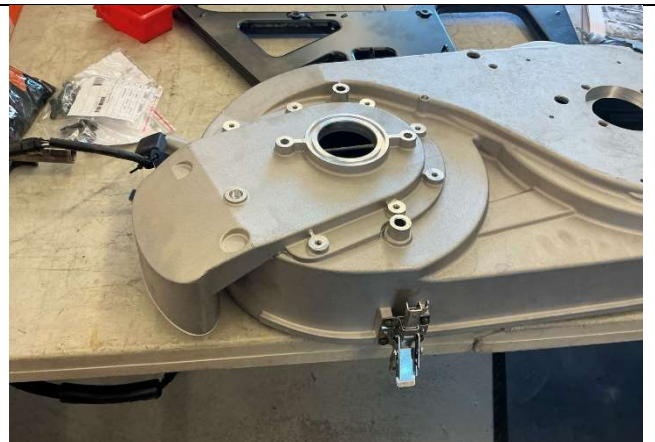

STEP 35 (continued):

Back intake plate installed on clutch case.



STEP 36:

Install the clutch case. One at a time, remove each tie bolt from the passenger side and reinstall it in its original orientation, starting with the upper tie bolt. Torque the tie bolts to 85 ft-lbs, then install the remaining hardware in the correct locations.

NOTE: Do not remove both tie bolts at the same time. Keep one tie bolt installed to maintain engine/transmission alignment.



STEP 37:

Drill a 10 mm hole 12 inches from the existing exhaust mounting hole, measuring center-to-center toward the driver side.



STEP 38:

Install the new driver-side exhaust mounting plate.



7. Rear Plate and Exhaust Install

STEP 39:

Position the rear crossmember, then install the two upper rear crossmember mounting bolts using a 19 mm socket and 19 mm wrench. Torque to 85 ft-lbs.

NOTE: Install the washers as shown: two washers under the bolt head and one washer under the nut.



STEP 39 (continued):

Washer orientation and rear crossmember mounting reference.

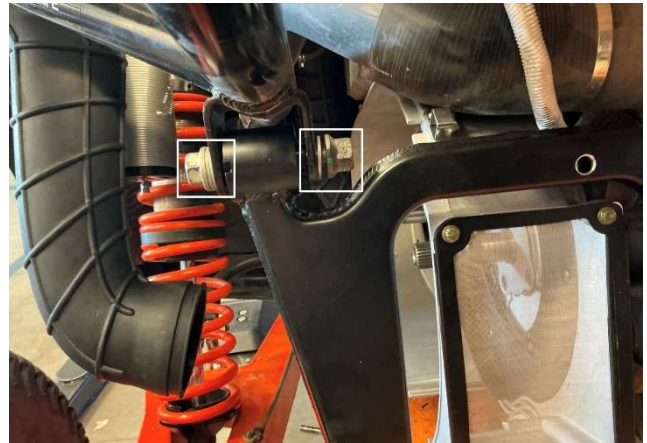

STEP 40:

Using a 13 mm socket and 14 mm wrench, install the two transmission mounting bolts.

NOTE: Insert the transmission mounting bolts from the passenger side. This is the reverse of the original bolt orientation.



STEP 41:

Using a 10 mm socket and 13 mm wrench, attach the rear crossmember to the mounting bracket.



STEP 42:

Position the muffler and partially thread the passenger-side mounting bolt to hold alignment. Support the center of the muffler as needed, then install the driver-side mounting bolt. Tighten both mounting bolts using a 13 mm socket.

NOTE: Use the new driver-side muffler mounting bolt included in the package.



STEP 43:

Install the exhaust pipe and tighten the exhaust clamps using an 11 mm socket.



8. Primary and Secondary Clutch Install

STEP 44:

Clean the center sleeves and sheaves on both clutches using brake cleaner or an equivalent residue-free cleaning solvent.



STEP 45:

Clean the primary and secondary clutch shafts using brake cleaner or an equivalent residue-free cleaning solvent. **Apply red grease to the secondary shaft splines only.**



STEP 46:

Wipe the primary clutch mounting bolt clean, then install the new oversized washer onto the bolt. Apply a light coating of anti-seize to the bolt threads.



STEP 47:

Install the primary clutch with the prepared mounting bolt. Using a T60 socket, extension, and torque wrench, torque the bolt to 90 ft-lbs.

NOTE: Small popping sounds are normal and expected as the primary clutch seats onto the shaft. If no popping is heard, verify that the shaft and clutch sleeve are clean and that the clutch is fully seated before proceeding.



STEP 48:

Install the secondary clutch.

1. Apply a light coating of anti-seize to the secondary clutch mounting bolt threads.
2. Insert the bolt through the secondary clutch.
3. Flip the clutch over and install the small spring inside the center sleeve and around the bolt.
4. Make sure the spring is seated evenly.
5. Install the secondary clutch and torque the mounting bolt to 65 ft-lbs.



STEP 48 (continued):

Secondary clutch spring and bolt orientation.

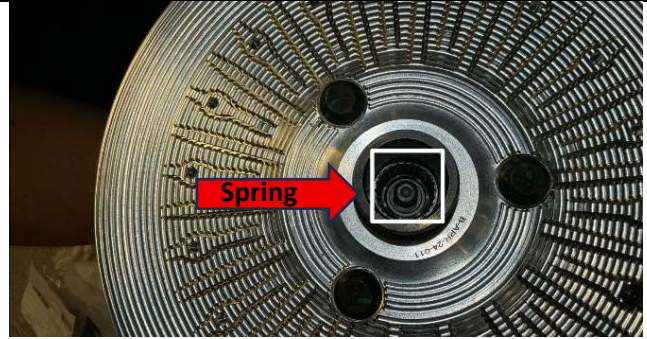

STEP 49:

Check secondary clutch movement. Push the outside of the secondary clutch toward the vehicle and release. If installed correctly, the clutch should spring back outward.



STEP 50:

Thread a bolt into the secondary clutch plate to relieve spring tension. **Make sure the bolt does not line up with a hole in the inner plate.**

WARNING: Keep fingers and hands clear while the secondary clutch is under spring tension.



STEP 51:

Install the CVT belt onto the primary and secondary clutches.

NOTE: Make sure the lower black plastic cover is removed from the clutch case before installing the CVT belt. Reinstall the lower black plastic cover after the belt is in place.



STEP 51 (continued):

Lower black plastic cover installation reference.



STEP 52:

Remove the bolt from the secondary clutch to release spring tension. Rotate the secondary clutch by hand to allow the CVT belt to settle into position.

NOTE: The CVT belt should sit nearly flush with the outer edge of the secondary clutch sheaves.



STEP 53:

Install the clutch cover.

1. Install the large cover piece first without latching.
2. Position the small cover piece into place and connect the two pieces using the two latches facing the shock.
3. Make sure the cover is fully seated, then secure all latches except the top latch.

NOTE: Make sure the correct clutch cover is installed. The bushings on the inside of the cover should sit flush in their locations and should not stick out.

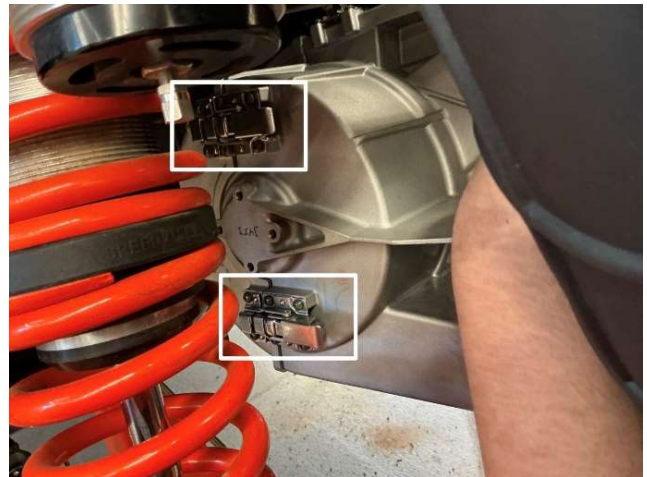
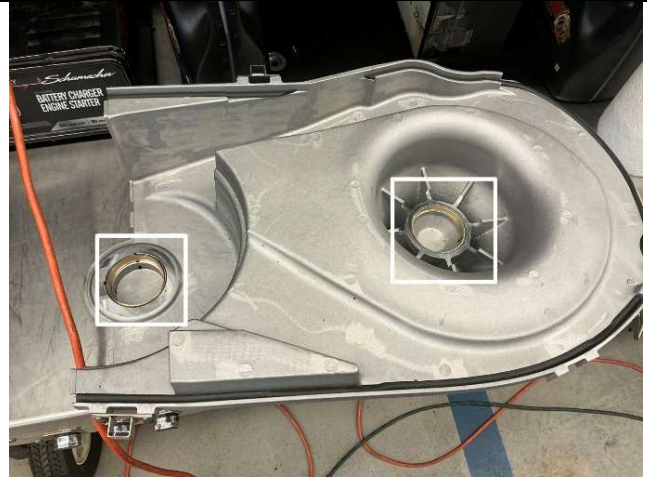

STEP 53 (continued):

Clutch cover latch reference

NOTE: The top latch will not latch.

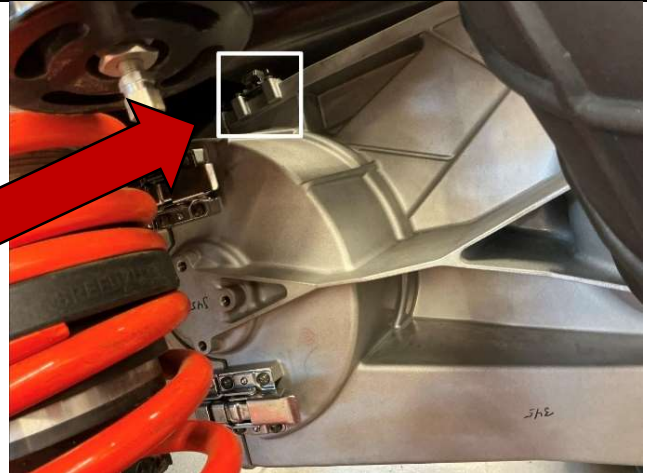

STEP 54:

Connect the hose to the side of the clutch cover and tighten the hose clamp using a 7 mm socket.



STEP 55:

Install the bed using a 5 mm hex. Reconnect the taillight wiring and camera wiring if equipped, then secure any loose wiring with zip ties.

