

# ***SPEED UTV DESIGN PRESENTATION: 58***



**ROBBY GORDON, TODD ROMANO**

**DANIEL GRANGER**

**5/12/21**



## PRIMARY CVT

**Here is a comparison between the billet prototype TAPP clutch and the forged production clutch**



**Forged Clutch on left, Billet Tapp on right**

## PRIMARY CVT

**Here is a comparison between the billet prototype TAPP clutch and the forged production clutch**



**Forged Clutch on left, Billet Tapp on right**

## PRIMARY CVT

**Here is a comparison between the billet prototype TAPP clutch and the forged production clutch**

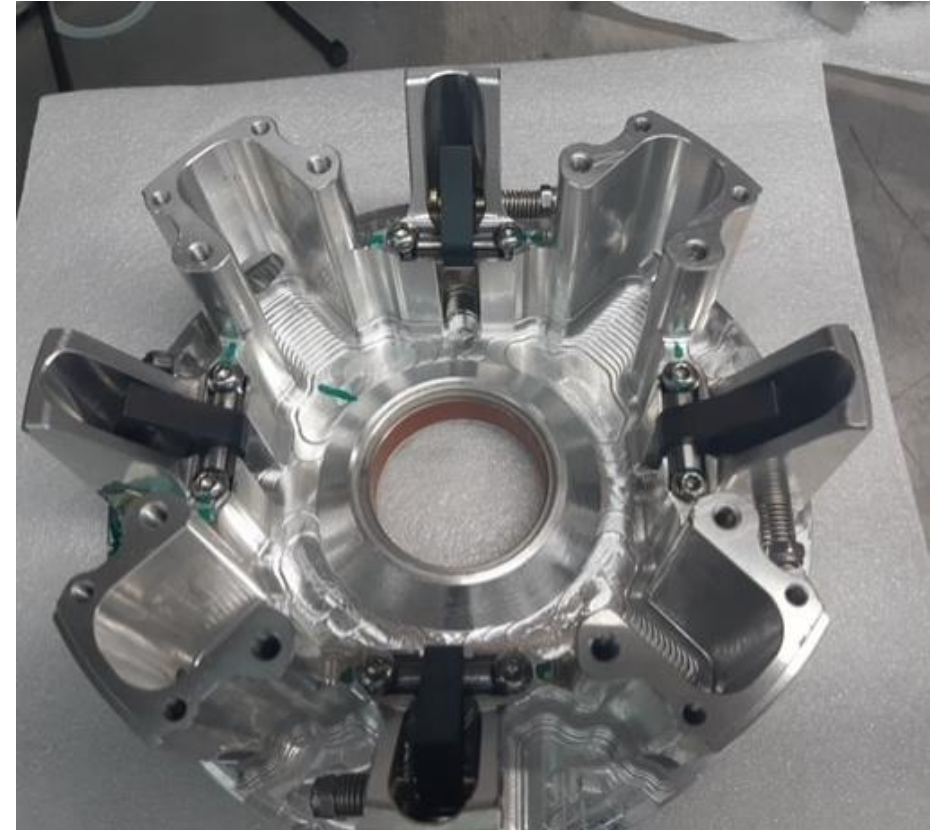
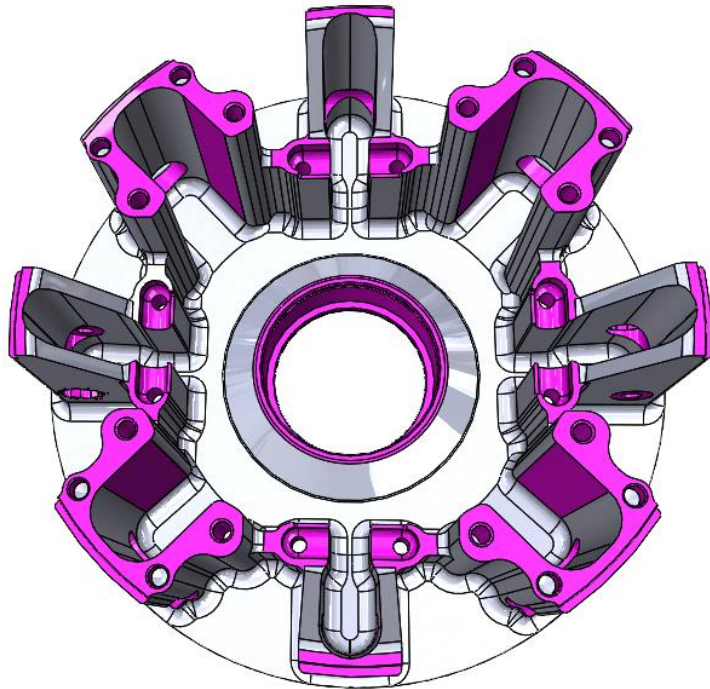

**Forged Clutch vs CAD**



## PRIMARY CVT

**Here is a comparison between the billet prototype TAPP clutch and the forged production clutch**

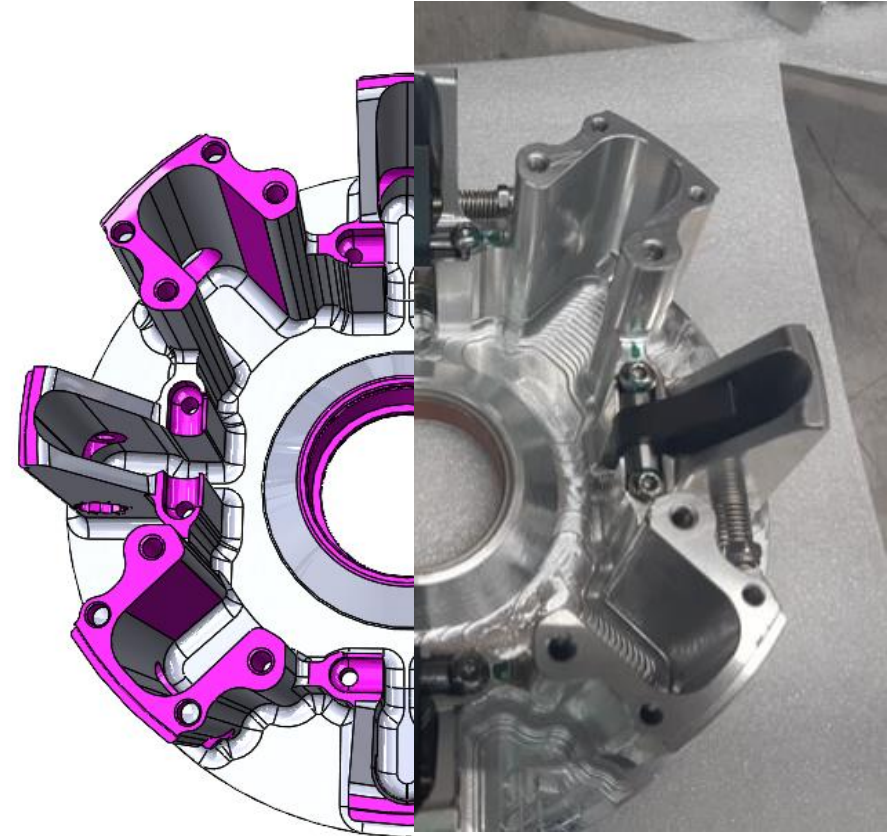
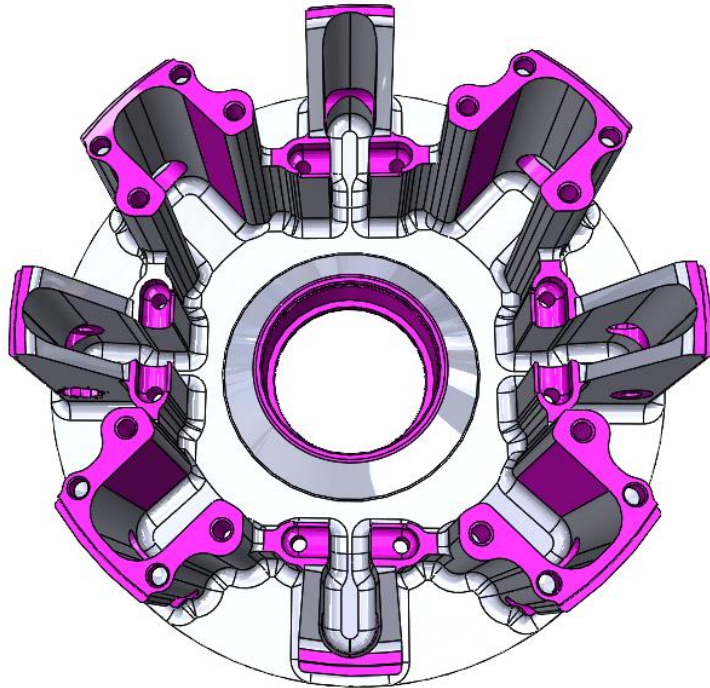

**Forged Clutch vs CAD**



# YOUR SAFETY : CAN AM

**SPEED UTV**



**O-2-thin tubing**



**Competitor's car split in two**



# YOUR SAFETY

**SPEED UTV**



**Front Suspension barely  
attached to main chassis**

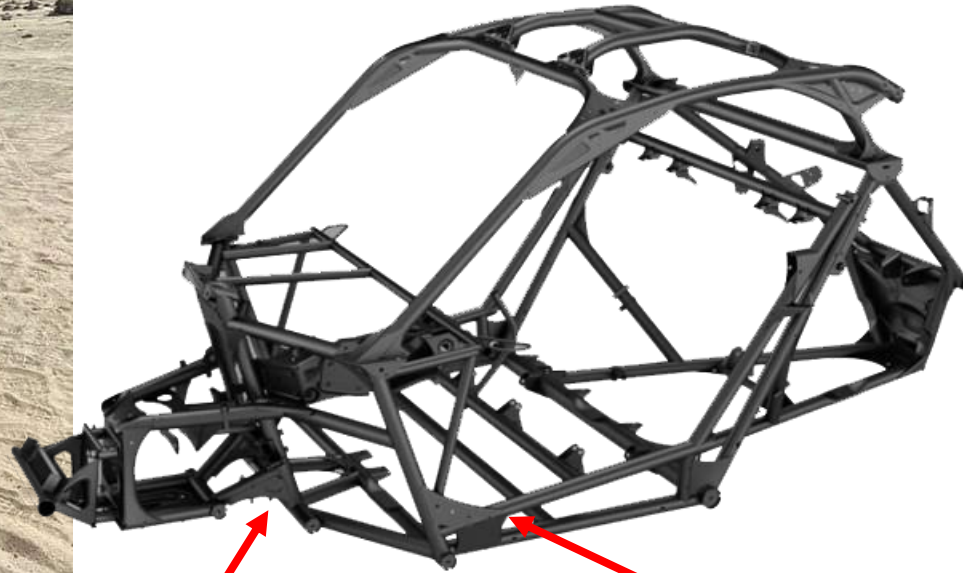

**Weak point in chassis main  
stiffness**



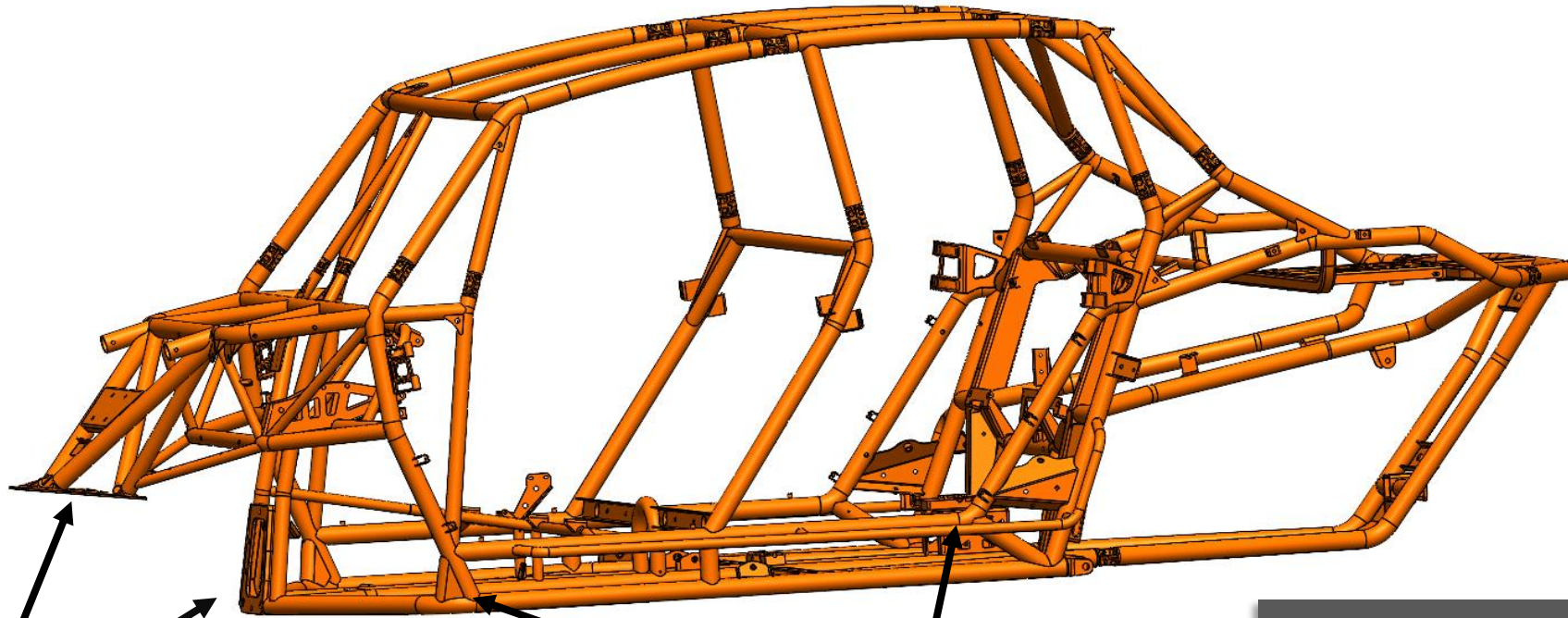

**Front bulkhead integrates  
securely into chassis  
attached to main chassis**

**Double tube main rail for  
greater stiffness, with  
additional gussets**

**0.095" minimum tube wall  
thickness**



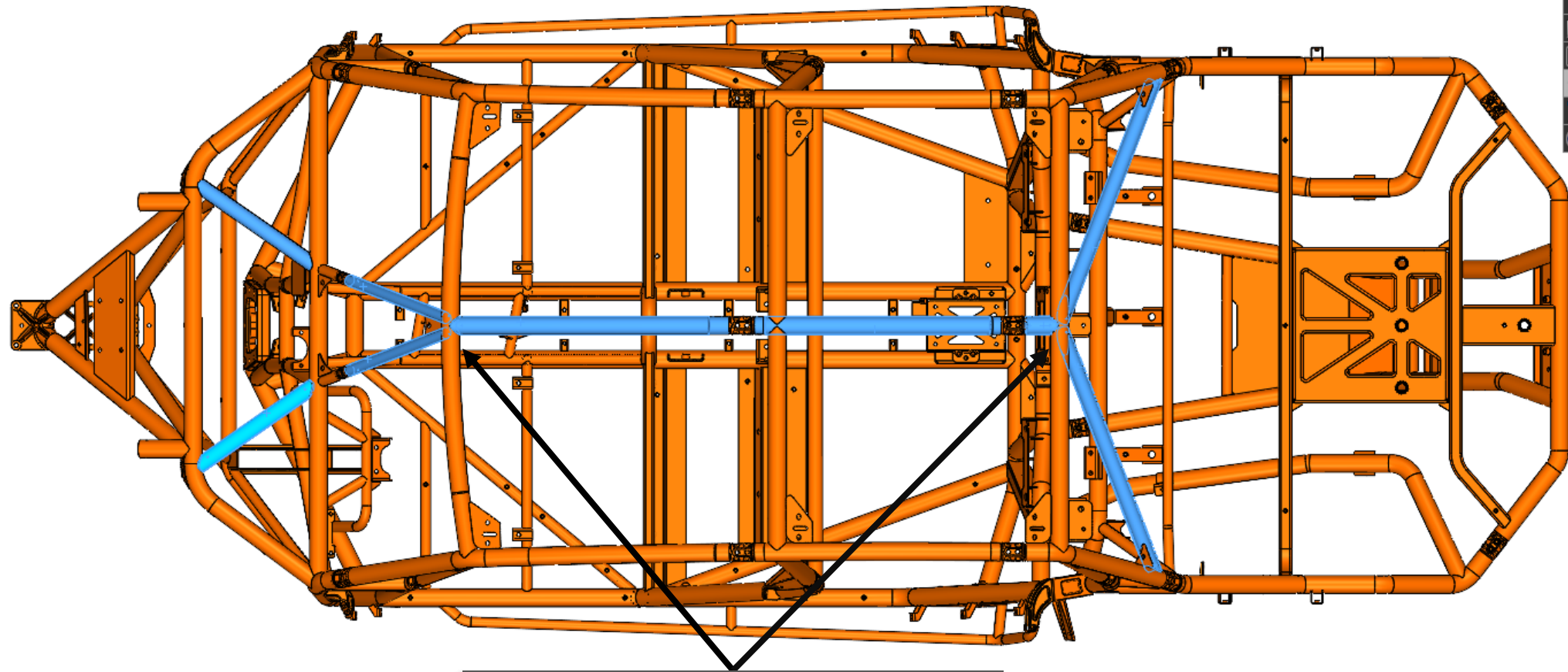

**Structural Center Spine  
distributes load to rest of  
chassis**

**Corner Gussets at all critical joints**

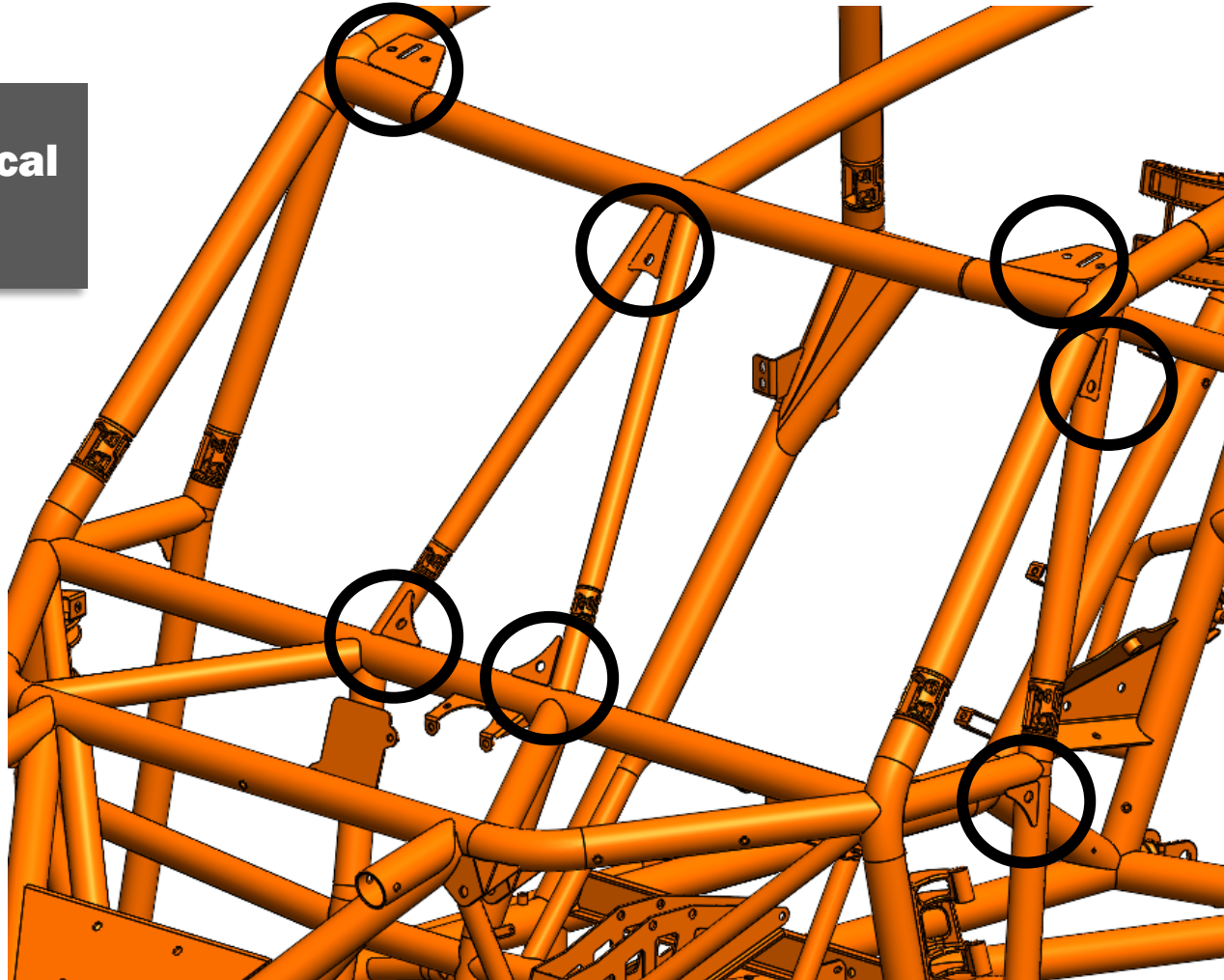



**Floor Plane tube  
triangulation directs and  
supports the suspension  
load**

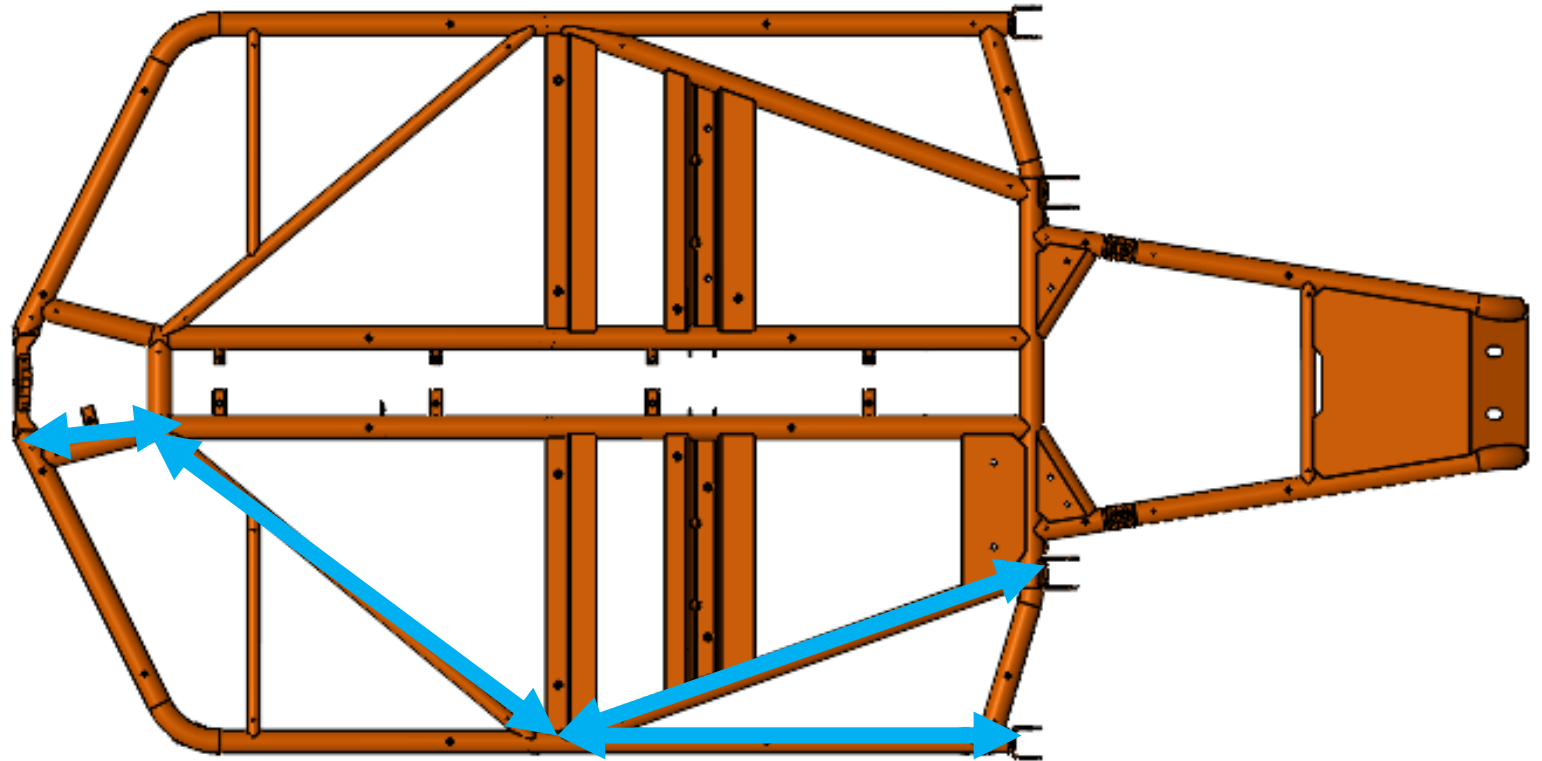

# Steering Geometry

**SPEED/UTV**

**Last week we talked about how changing the wheel offset can affect your steering geometry, tonight we'll go more in depth about what makes the geometry good to begin with.**



**El Jefe Testing in Parker, Az.**



**The Speed UTV has almost zero bumpsteer.**

**The toe change over the entire travel is less than 0.5 deg which translated to about 1/8" per side.**

**Minimizing bumpsteer is a critical component in designing suspension that handles well. It provides consistent steering input throughout the wheel travel.**



**Some of our competitors have made significant compromises on their suspension design which has resulted in significant bump steer among other issues.**



**Adding wider wheels pushes the tire out and increases the scrub radius**





**Work Light comes standard with an RGB Blue Tooth Controller, with over 16 million colors. Designed with Black Aluminum housing for both corrosion and durability.**

**Speed LEDs feature waterproof plug-n-play connectors that are easily wired to one central control box module. Simply connect the control box to a power source and run all the wiring to one central location on your vehicle for a seamless install.**



**4 Lights per kit.**



**Tony Cola Is Back to discuss our plans for racing and high power build support**

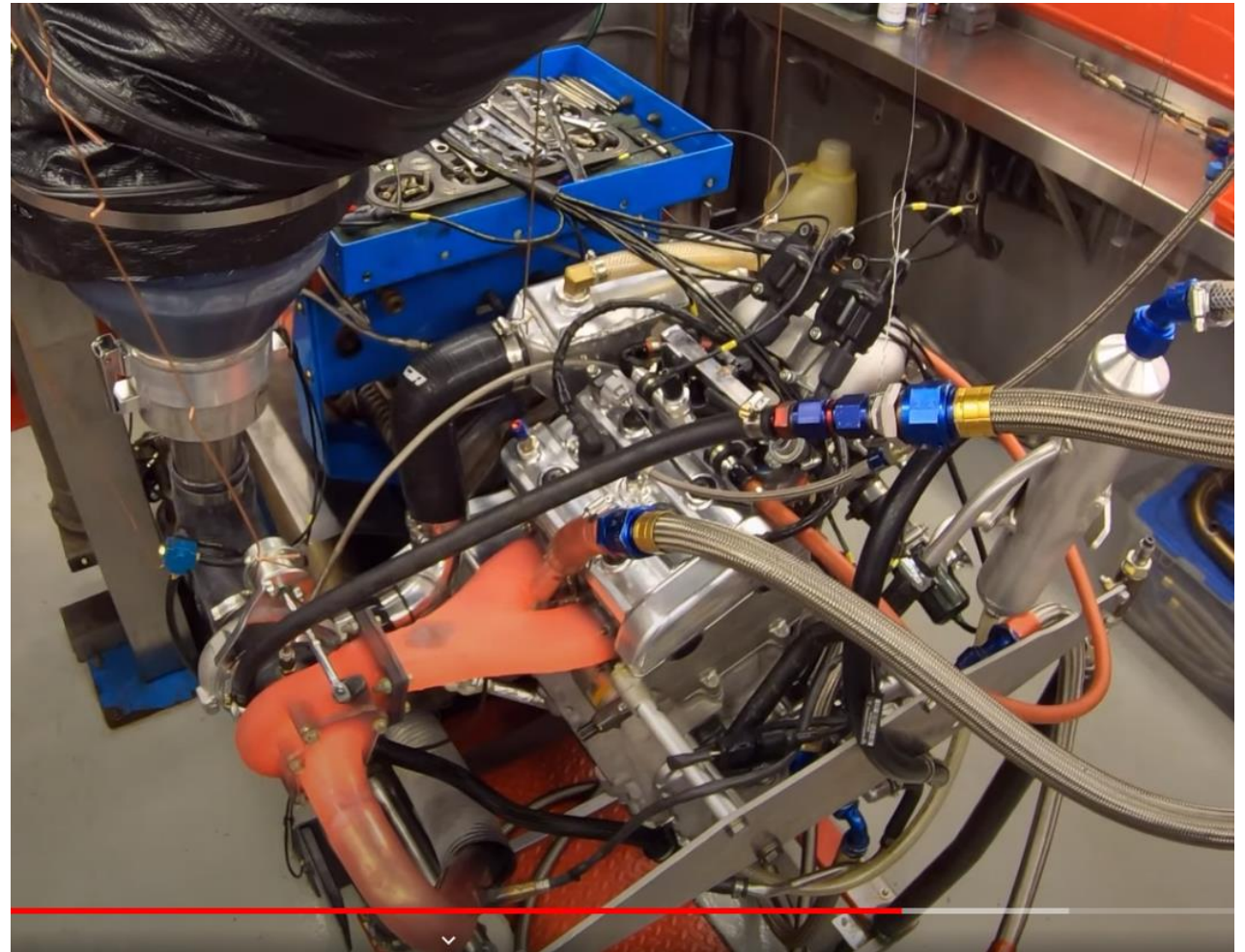

# Tail Lights

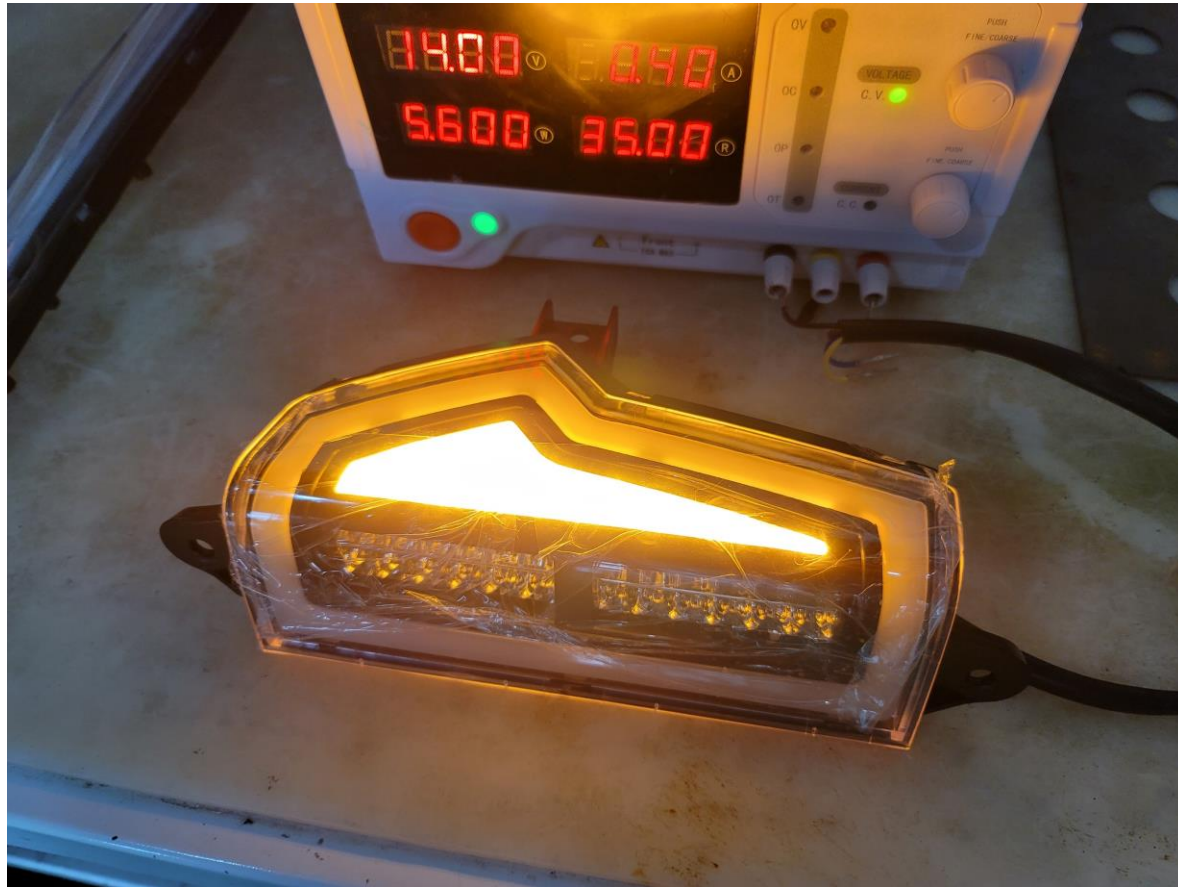



# Head Lights



## Head Lights









# Aluminum Tie Rods





**Call in with your questions:**

**704-949-1255**



**Lucky Caller wins a**

